

220-240V 50Hz 1~**GENERAL DATA**

Application: LBP
Refrigerant: R600a
Evaporating Temperature Range: -35°C to -10°C
Compressor Cooling: Static
Maximum Condensing Pressure - Operating: 6.73 bar
Maximum Condensing Pressure - Peak: 7.69 bar
Type: Hermetic reciprocating
Technology Type: On-Off
Expansion Device: Capillary Tube
Packing Quantity: Single - 1 pc
Displacement: 7.96 cm³
Horse power: 1/7 hp

Approvals:   

MECHANICAL DATA

Bore: 24 mm
Stroke: 17.6 mm
Oil Charge: 150ml +/-15ml
Free Internal Volume: 1.5 cm³
Maximum Recommended Refrigerant Charge: 150 g
Oil Type Configuration: Alkylbenzene
Oil Type Viscosity: ISO2
Compressor pressurization: Light vacuum
Weight: 7.5 kg

ELECTRICAL DATA

Motor Type: RSCR
Starting Torque: LST
Voltage working range at 50 Hz: 198-254 V
Maximum Motor Temperature: 130 °C
Start Winding Resistance: 20.2 Ω (± 10%) at 25°C
Run Winding Resistance: 30.8 Ω (± 10%) at 25°C

MOUNTING ACCESSORIES

	Description	Code
Terminal Board:	no	-
Overload Protector Bracket:	no	-
Washer:	no	-
Pin:	no	-
Clip:	no	-
Rotolock valve:	no	-
Cover:	yes	2075282
Anchorage:	yes	1027058
Grommets:	yes	2221011
Sleeves:	yes	2222018
Capacitor Bracket:	yes	2256008

ELECTRICAL COMPONENTS

	Component type	Description	Code
Starting Device:	PTC	PTC 230V	1260011
Motor Protection:	External 3/4"	AE64FS8	2288503
Run Capacitor:		4 MFD	2253110

EXTERNAL CHARACTERISTICS

Base Plate: European
Tray Holder: Yes
Height: 166 mm

	Internal Diameter (mm)	Material	Shape
Suction Connector	6.1	Copper	Slanted 42°
Discharge Connector	5.1	Copper	Slanted 48°
Process Connector	5.92	Copper	Slanted 43°

RATED POINT DATA

Cooling Capacity (W)	Power Consumption (W)	Current Consumption (A)	Gas Flow Rate (kg/h)	Efficiency (W/W)
±5%	±5%	±5%	±5%	±7%
133	74	0.35	1.42	1.80

Test condition: ASHRAE, Static, Return Gas 32.2°C, Evaporating: -23.3°C, Condensing: 54°C, Ambient: 32.2°C, Liquid: 32.2°C

PERFORMANCE CURVE DATA

220V 50Hz

Condensing Temperature (°C)	Evaporating Temperature (°C)	Cooling Capacity (W)	Power Consumption (W)	Current Consumption (A)	Gas Flow Rate (kg/h)	Efficiency (W/W)
		±5%	±5%	±5%	±5%	±7%
35°C	-10	283	88	0.41	3.04	3.22
	-15	228	80	0.37	2.44	2.84
	-20	179	72	0.34	1.92	2.49
	-25	137	64	0.30	1.47	2.15
	-30	101	55	0.26	1.08	1.82
	-35	69	47	0.23	0.74	1.48

Condensing Temperature (°C)	Evaporating Temperature (°C)	Cooling Capacity (W)	Power Consumption (W)	Current Consumption (A)	Gas Flow Rate (kg/h)	Efficiency (W/W)
		±5%	±5%	±5%	±5%	±7%
45°C	-10	269	97	0.46	2.89	2.78
	-15	215	87	0.41	2.31	2.49
	-20	169	77	0.37	1.81	2.21
	-25	129	67	0.32	1.38	1.94
	-30	95	57	0.28	1.02	1.67
	-35	67	47	0.24	0.71	1.41

Condensing Temperature (°C)	Evaporating Temperature (°C)	Cooling Capacity (W)	Power Consumption (W)	Current Consumption (A)	Gas Flow Rate (kg/h)	Efficiency (W/W)
		±5%	±5%	±5%	±5%	±7%
55°C	-10	256	106	0.50	2.75	2.41
	-15	203	93	0.44	2.18	2.17
	-20	158	81	0.39	1.69	1.93
	-25	119	70	0.33	1.28	1.71
	-30	88	59	0.29	0.94	1.49
	-35	62	48	0.24	0.66	1.28

Test condition: ASHRAE, Static, Return Gas 32.2°C, Evaporating: -23.3°C, Condensing: 54°C, Ambient: 32.2°C, Liquid: 32.2°C

ASSEMBLY INSTRUCTION

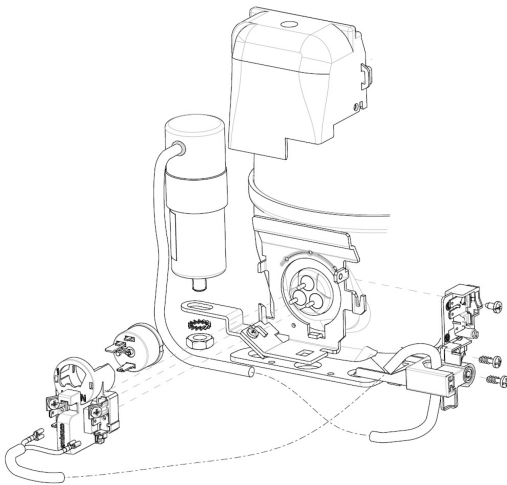

WIRING DIAGRAM

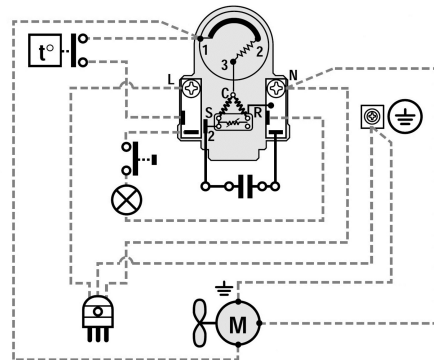

OPERATING ENVELOPE

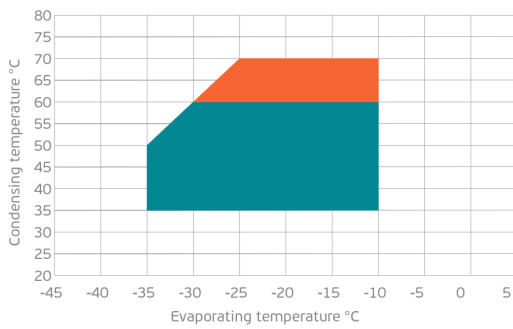

- Operating Condition
- Transient Condition
- Superheating

NOTE: usage of compressors outside of intended working range cannot make use of the warranty, or should be consulted with Technical support.

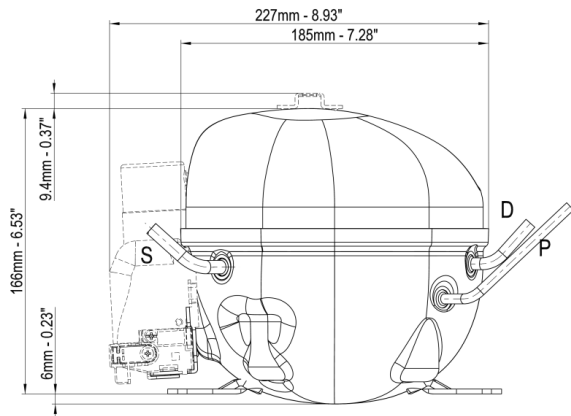

	∅ mm	∅ in	Material
S - Suction	6.10 - 6.20	0.24	Cu
P - Process	5.92 - 6.08	0.23	Cu
D - Discharge	5.10 - 5.20	0.20	Cu

