

COMPRESSOR

Displacement (cm ³)	16
Diameter (mm)	31.18
Stroke (mm)	21.13
Net Weight (Kg)	13.1
Oil type	ISO VG 22 ESTER
Oil charge (cm ³)	400

MOTOR

Approximate Power (CV)	3/8
Voltage/Frequency (V/Hz)	220V 50Hz
Voltage range (V)	187-264
Code	61,572
Type	CSIR
Phase number	1 PH
Locked rotor current (A)	20.0
Main W. resist. at 25°C (Ω)	3.77
Start W. resist. at 25°C (Ω)	20.39

APPLICATION

Application	High back pressure
Refrigerant	R134a
Evaporating (°C)	-15 to 10
Expansion	Capillar/Valve
Comp. cooling	Fan cooled
Max. ambient temp. (°C)	43

NOMINAL PERFORMANCE

	CYCLE C	CYCLE D
Cooling capacity (W)	1205	1442
Input power (W)	666	690
EER (kcal/Wh)	1.55	1.79
COP (W/W)	1.80	2.09
Current (A)	3.90	4.00

TEST CONDITIONS

Evaporating temp. (°C)	5.0	7.2
Condensing temp. (°C)	55.0	55.0
Liq.t. entering expan. (°C)	55.0	46.0
Ambient t. and return (°C)	32.0	35.0
Tens/Freq (V/Hz)	220V 50Hz	220V 50Hz

ELECTRICAL COMPONENTS

Relay	9660 A 158	MTRP 51
Pick-Up (A)	9,15	9,05
Drop-Out (A)	7,70	7,70
Protector	MRP00AMK	T0425
Current (A)	11.7	11.5
Time check (seg)	7.5-14	7.5-14
Disc temp. (Open/Close) (°C)	105.0 / 61.0	105.0 / 61.0
Starting capacitor (μF/V)/F/V)	72- 88 / 330	

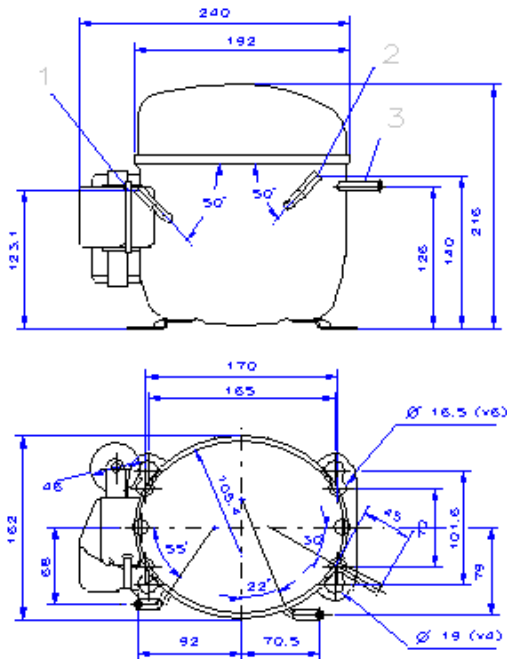
DIMENSIONS AND ELECTRICAL DIAGRAM

	DESIGNATION	INTERNAL DIAM. (MM)
1	Suction	8,1
2	Service	8,1
3	Discharge	6,5

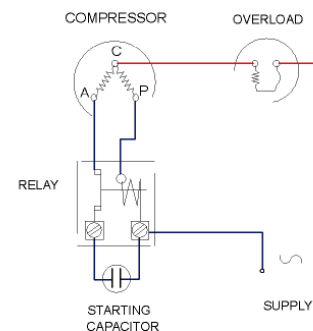
CSIR

TEST CONDITIONS

Voltage/frequency	220V 50Hz
Ambient t. and return	35 °C
Liq.t. entering expan.	Subcooling 9 K

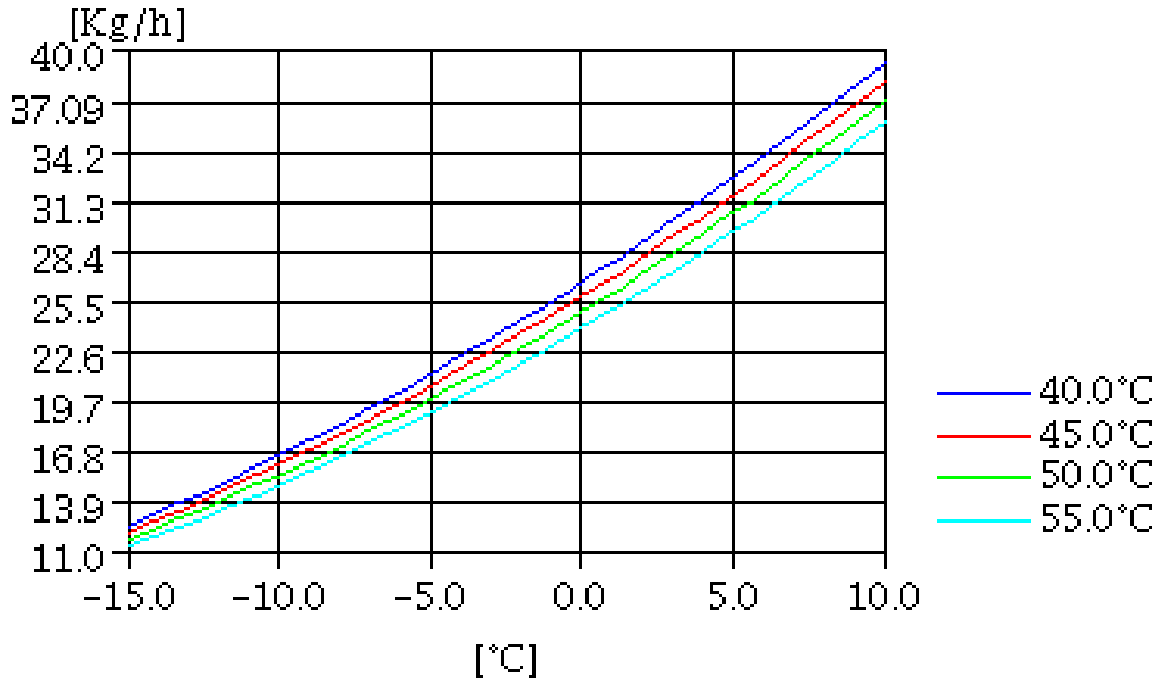
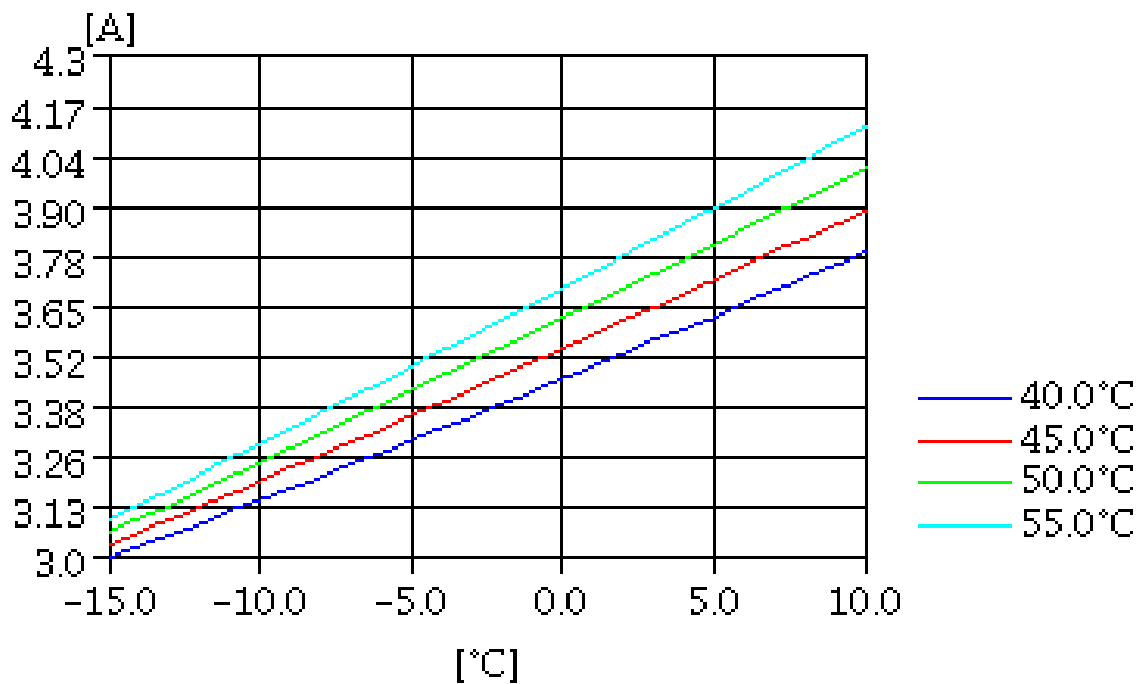
MASS FLOW

CONSUMPTION

TEST CONDITIONS

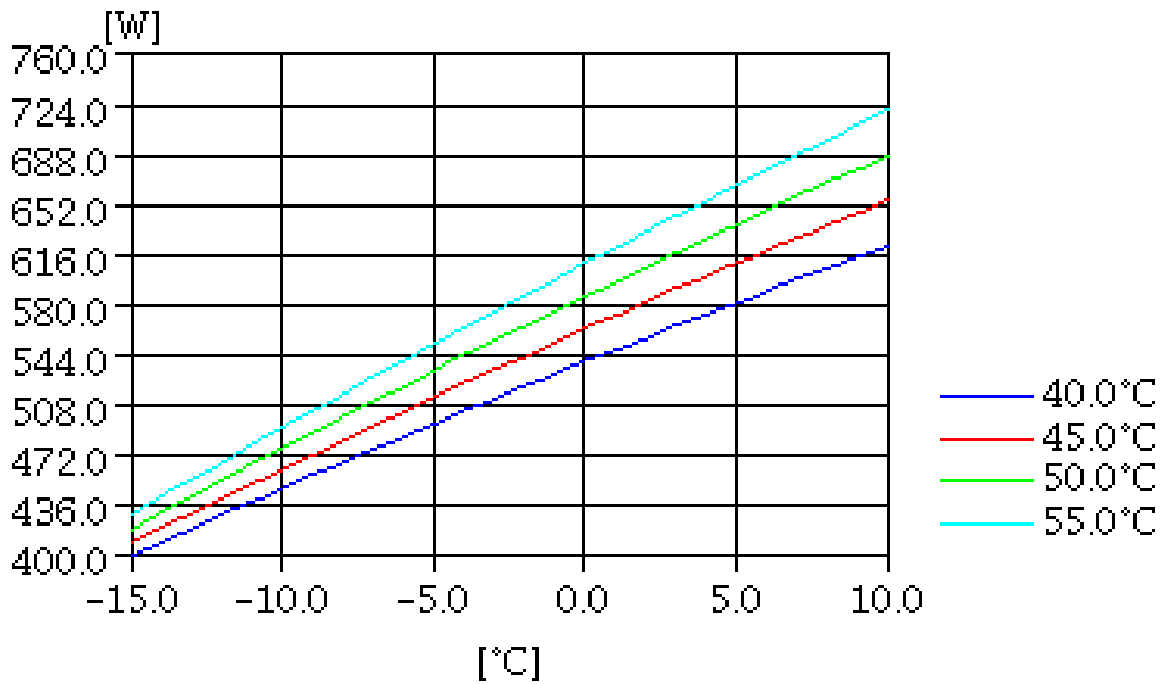
Voltage/frequency	220V 50Hz
Ambient t. and return	35 °C
Liq.t. entering expan.	Subcooling 9 K

INPUT W

COOLING CAPACITY
