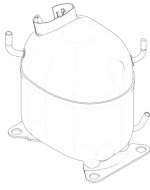

220-240V 50Hz 1~**GENERAL DATA****Application:** HBP**Refrigerant:** R407C**Compressor Cooling:** Fan**Fan air flow:** 800 m3/h**Maximum Condensing Pressure - Operating:** 21.45 bar**Maximum Condensing Pressure - Peak:** 24.29 bar**Type:** Hermetic reciprocating**Technology Type:** On-Off**Expansion Device:** Capillary Tube**Packing Quantity:** Single - 1 pc**Displacement:** 26.1 cm3**Horse power:** 1 hp**Approvals:** **MECHANICAL DATA****Bore:** 41.77 mm**Stroke:** 19.07 mm**Oil Charge:** 750ml +/-15ml**Free Internal Volume:** 3.9 cm3**Maximum Recommended Refrigerant Charge:** 800 ml**Oil Type Configuration:** Polyolester**Oil Type Viscosity:** ISO22**Compressor pressuriazation:** Dry air charge**Weight:** 20.8 kg**ELECTRICAL DATA****Motor Type:** PSC**Starting Torque:** HST**Voltage working range at 50 Hz:** 198-254 V**Maximum Motor Temperature:** 130 °C**Start Winding Resistance:** 7.76 Ω (± 10%) at 25°C**Run Winding Resistance:** 1.78 Ω (± 10%) at 25°C**MOUNTING ACCESSORIES**

	Description	Code
Cover:	yes	2075281
Terminal Board:	no	-
Anchorage:	no	-
Overload Protector Bracket:	no	-
Capacitor Bracket:	no	-
Grommets:	yes	2221004
Sleeves:	yes	2222016
Washer:	no	-
Pin:	no	-
Clip:	no	-
Rotolock valve:	no	-

ELECTRICAL COMPONENTS

	Component type	Description	Code
Motor Protection:	External 1"	GA3VMS0002	2295006
Run Capacitor:	25 MFD		2253216

EXTERNAL CHARACTERISTICS**Base Plate:** LARGE**Tray Holder:** No**Height:** 265 mm

	Internal Diameter (mm)	Material	Shape
Suction Connector	9.6	Copper	Vertical
Discharge Connector	8	Copper	Slanted 65°
Process Connector	6.42	Copper	Vertical



RATED POINT DATA

Cooling Capacity (W)	Power Consumption (W)	Current Consumption (A)	Gas Flow Rate (kg/h)	Efficiency (w/W)
±5%	±5%	±5%	±5%	±7%
992	1 382	6.61	68.71	0.72

Test condition: ASHRAE, Fan, Return Gas 35°C, Subcooling 8.3K, Evaporating: 7.2°C, Condensing: 54°C, Ambient: 35°C

PERFORMANCE CURVE DATA

220V 50Hz

Condensing Temperature (°C)	Evaporating Temperature (°C)	Cooling Capacity (W)	Power Consumption (W)	Current Consumption (A)	Gas Flow Rate (kg/h)	Efficiency (w/W)
		±5%	±5%	±5%	±5%	±7%
35°C	15	5 955	1 202	5.64	105.77	4.95
	10	5 012	1 147	5.50	88.26	4.37
	5	4 151	1 096	5.33	72.56	3.79
	0	3 373	1 051	5.15	58.55	3.21

Condensing Temperature (°C)	Evaporating Temperature (°C)	Cooling Capacity (W)	Power Consumption (W)	Current Consumption (A)	Gas Flow Rate (kg/h)	Efficiency (w/W)
		±5%	±5%	±5%	±5%	±7%
45°C	15	5 232	1 372	6.48	99.93	3.81
	10	4 366	1 299	6.21	82.49	3.36
	5	3 594	1 223	5.90	67.28	2.94
	0	2 916	1 145	5.56	54.17	2.55

Condensing Temperature (°C)	Evaporating Temperature (°C)	Cooling Capacity (W)	Power Consumption (W)	Current Consumption (A)	Gas Flow Rate (kg/h)	Efficiency (w/W)
		±5%	±5%	±5%	±5%	±7%
55°C	15	4 509	1 542	7.32	94.09	2.92
	10	3 721	1 451	6.92	76.72	2.56
	5	3 037	1 350	6.47	62.00	2.25
	0	2 460	1 239	5.97	49.79	1.99

Test condition: ASHRAE, Fan, Return Gas 35°C, Subcooling 8.3K, Evaporating: 7.2°C, Condensing: 54°C, Ambient: 35°C

ASSEMBLY INSTRUCTION

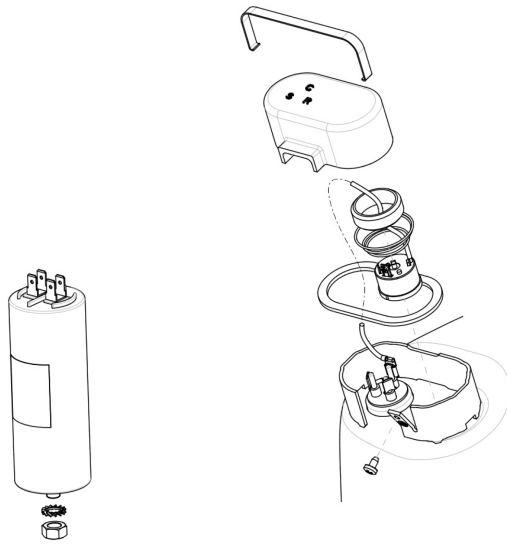

WIRING DIAGRAM

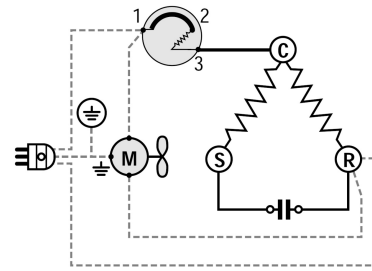

OPERATING ENVELOPE

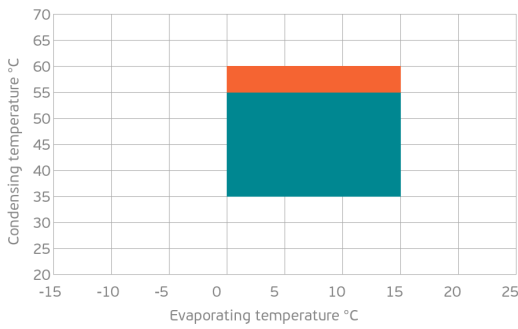

- Operating Condition
- Transient Condition
- Superheating

NOTE: usage of compressors outside of intended working range cannot make use of the warranty, or should be consulted with Technical support.

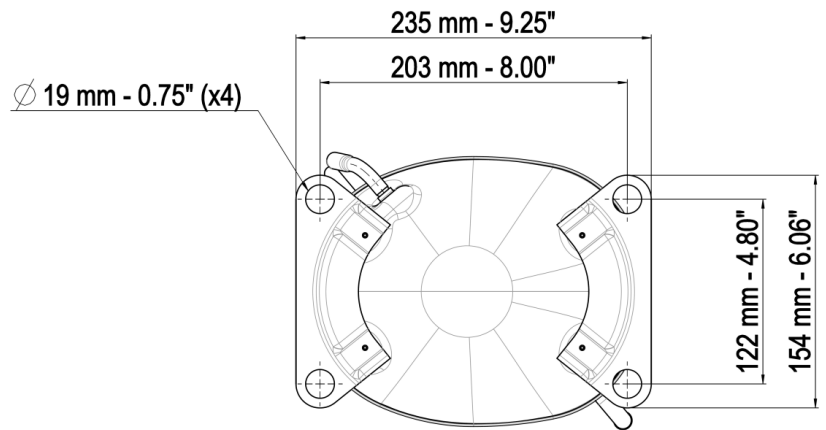
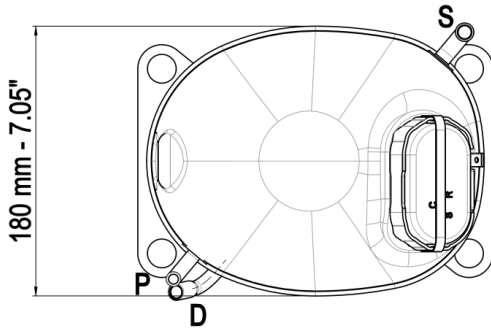
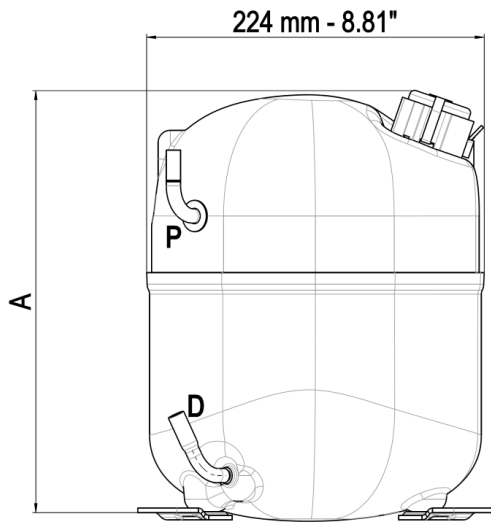

	∅ mm	∅ in	material
S - Suction	9.60 - 9.67	3/8	Cu
	12.77 - 12.85	1/2	Cu
P - Process	6.42 - 6.50	1/4	Cu
D - Discharge	6.42 - 6.50	1/4	Cu
	8.00 - 8.08	5/16	Cu