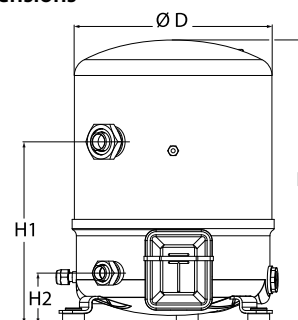
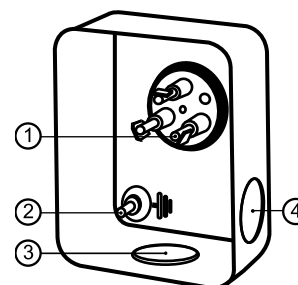

General Characteristics

Model number (on compressor nameplate)		NTZ096A4LR1B
Code number for Singlepack*		120F0234
Code number for Industrial pack**		120F0235
Drawing number		8502012g
Suction and discharge connections		Rotolock
Suction connection		1-3/4" Rotolock
Discharge connection		1-1/4" Rotolock
Suction connection with supplied sleeve		7/8" ODF
Discharge connection with supplied sleeve		3/4" ODF
Oil sight glass		Threaded
Oil equalisation connection		3/8" flare SAE
Oil drain connection		None
LP gauge port		Schrader
IPR valve		30 bar / 8 bar
Cylinders		2
Swept volume		96 cm ³ /rev
Displacement @ Nominal speed		16.7 m ³ /h @ 2900 rpm - 20.2 m ³ /h @ 3500 rpm
Net weight		35 kg
Oil charge		1.8 litre, POE - 175PZ
Maximum system test pressure Low Side / High side		25 bar(g) / 30 bar(g)
Maximum differential test pressure		30 bar
Maximum number of starts per hour		12
Refrigerant charge limit		5 kg
Approved refrigerants		R404A, R452A

Dimensions

D=288 mm
H=413 mm
H1=265 mm
H2=74 mm
H3=- mm

Terminal box

IP55 (with cable gland)

- 1: Spade connectors 1/4"
- 2: Earth M4-12
- 3: Knock-out Ø 21 mm (0.83")
- 4: Hole Ø 21 mm (0.83")

Electrical Characteristics

Nominal voltage	380-400V/3/50Hz - 460V/3/60Hz
Voltage range	340-440 V @ 50Hz - 414-506 V @ 60Hz
Winding resistance (between phases) +/- 7% at 25°C	5.03 Ω
Maximum Continuous Current (MCC)	10.1 A
Locked Rotor Amps (LRA)	32 A
Motor protection	Internal overload protector

Recommended Installation torques

Oil sight glass	50 Nm
Power connections / Earth connection	2 Nm / 2 Nm
Mounting bolts	15 Nm

Parts shipped with compressor

Mounting kit with grommets, bolts, nuts, sleeves and washers
Suction & Discharge solder sleeves, rotolock nuts and gaskets (shipped with rotolock version only)
Initial oil charge
Installation instructions

Approvals : CE certified, -, -

*Singlepack: Compressor in cardboard box

**Industrial pack: 6 Unboxed compressors on pallet (order per multiples of 6)

Rotolock accessories, suction side

Code no.

Solder sleeve, P07 (1-3/4" Rotolock, 7/8" ODF)	8153013
Angle adapter, C07 (1-3/4" Rotolock, 7/8" ODF)	8168008
Rotolock valve, V07 (1-3/4" Rotolock, 7/8" ODF)	8168032
Gasket, 1-3/4"	8156132

Gaskets, sleeves and nuts

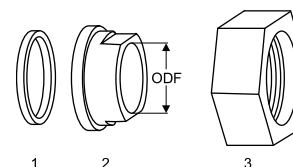

- 1: Gasket
- 2: Solder sleeve
- 3: Rotolock nut

Rotolock accessories, discharge side

Code no.

Solder sleeve, P04 (1-1/4" Rotolock, 3/4" ODF)	8153008
Angle adapter, C04 (1-1/4" Rotolock, 3/4" ODF)	8168006
Rotolock valve, V04 (1-1/4" Rotolock, 3/4" ODF)	8168029
Gasket, 1-1/4"	8156131

Rotolock accessories, sets

Code no.

Angle adapter set, C07 (1-3/4"~7/8"), C04 (1-1/4"~3/4")	7703013
Valve set, V07 (1-3/4"~7/8"), V04 (1-1/4"~3/4")	7703006
Gasket set, 1", 1-1/4", 1-3/4", OSG gaskets black & white	8156009

Oil / lubricants

Code no.

POE lubricant, 175PZ, 1 litre can	120Z0638
POE lubricant, 175PZ, 2.5 litre can	120Z0639

Crankcase heaters

Code no.

PTC heater 27W, CE mark, UL	120Z0459
Belt type crankcase heater, 65 W, 230 V, CE mark, UL	7773107
Belt type crankcase heater, 65 W, 400 V, CE mark, UL	7773117
Belt type crankcase heater, 65 W, 460 V, CE mark, UL	120Z0466

Mounting kit

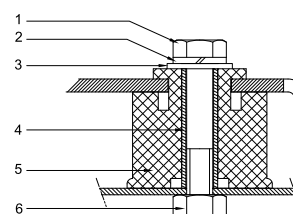

- 1: Bolt (3x)
- 2: Lock washer (3x)
- 3: Flat washer (3x)
- 4: Sleeve (3x)
- 5: Grommet (3x)
- 6: Nut (3x)

Miscellaneous accessories

Code no.

Acoustic hood for 2 cylinder compressor	120Z0472
Oil equalisation nut	8153127

Spare parts

Code no.

Mounting kit for 1 and 2 cylinder compressor, including 3 grommets, 3 bolts	8156001
Oil sight glass with gaskets (black & white)	8156019
Gasket for oil sight glass (black chloroprene)	8156145
Service kit for terminal box 80 x 96 mm, including 1 cover, 1 clamp	8156134

Danfoss can accept no responsibility for possible errors in catalogues, brochures and other printed material. Danfoss reserves the right to alter its products without notice. This also applies to products already on order provided that such alternations can be made without subsequential changes being necessary in specifications already agreed. All trademarks in this material are property of the respective companies. Danfoss, the Danfoss logotype and Maneurop are trademarks of Danfoss A/S. All rights reserved.

Performance data at 50 Hz, EN 12900 rating conditions, Suction temp. = 20 °C
R452A

Cond. temp. in °C (tc)	Evaporating temperature in °C (to)							
	-45	-40	-35	-30	-25	-20	-15	-10

Cooling capacity in W

30	-	-	2 639	3 611	4 803	6 233	7 921	9 883	-
35	-	-	2 352	3 250	4 357	5 690	7 269	9 111	-
40	-	-	2 065	2 886	3 904	5 136	6 603	8 321	-
45	-	-	-	2 523	3 448	4 576	5 926	7 516	-
50	-	-	-	-	2 993	4 013	5 243	6 701	-
55	-	-	-	-	-	3 451	4 558	5 881	-
60	-	-	-	-	-	-	-	-	-

Power input in W

30	-	-	1 678	1 974	2 262	2 531	2 768	2 964	-
35	-	-	1 670	1 994	2 320	2 637	2 933	3 197	-
40	-	-	1 650	2 001	2 363	2 725	3 076	3 405	-
45	-	-	-	1 994	2 389	2 794	3 197	3 589	-
50	-	-	-	-	2 399	2 843	3 297	3 748	-
55	-	-	-	-	-	2 875	3 375	3 883	-
60	-	-	-	-	-	-	-	-	-

Current consumption in A

30	-	-	3.30	3.67	4.05	4.42	4.76	5.05	-
35	-	-	3.27	3.67	4.09	4.52	4.93	5.31	-
40	-	-	3.25	3.67	4.13	4.62	5.11	5.57	-
45	-	-	-	3.66	4.17	4.71	5.27	5.83	-
50	-	-	-	-	4.18	4.78	5.41	6.06	-
55	-	-	-	-	-	4.82	5.53	6.26	-
60	-	-	-	-	-	-	-	-	-

Mass flow in kg/h

30	-	-	64	87	116	152	194	244	-
35	-	-	60	82	111	146	188	237	-
40	-	-	55	77	105	139	181	230	-
45	-	-	-	72	99	132	173	221	-
50	-	-	-	-	92	124	164	211	-
55	-	-	-	-	-	116	154	200	-
60	-	-	-	-	-	-	-	-	-

Coefficient of performance (C.O.P.)

30	-	-	1.57	1.83	2.12	2.46	2.86	3.33	-
35	-	-	1.41	1.63	1.88	2.16	2.48	2.85	-
40	-	-	1.25	1.44	1.65	1.89	2.15	2.44	-
45	-	-	-	1.27	1.44	1.64	1.85	2.09	-
50	-	-	-	-	1.25	1.41	1.59	1.79	-
55	-	-	-	-	-	1.20	1.35	1.51	-
60	-	-	-	-	-	-	-	-	-

Nominal performance at to = -35 °C, tc = 40 °C

Cooling capacity	2 065	W
Power input	1 650	W
Current consumption	3.25	A
Mass flow	55	kg/h
C.O.P.	1.25	

Pressure switch settings

Maximum HP switch setting	27.7	bar(g)
Minimum LP switch setting	0.1	bar(g)
LP pump down setting	0.1	bar(g)

Sound power data

Sound power level		dB(A)
With acoustic hood		dB(A)

to: Evaporating temperature at dew point

tc: Condensing temperature at dew point

Rating conditions : Suction gas temp. = 20 °C , Subcooling = 0 K

Tolerance according EN12900

Performance data at 50 Hz, EN 12900 rating conditions, Superheat = 10 K
R452A

Cond. temp. in °C (tc)	Evaporating temperature in °C (to)							
	-45	-40	-35	-30	-25	-20	-15	-10

Cooling capacity in W

30	-	1 689	2 415	3 344	4 500	5 906	7 587	9 566	-
35	-	1 457	2 116	2 965	4 029	5 332	6 899	8 753	-
40	-	1 233	1 821	2 587	3 556	4 752	6 200	7 925	-
45	-	-	1 536	2 215	3 085	4 169	5 494	7 087	-
50	-	-	-	1 853	2 620	3 589	4 787	6 241	-
55	-	-	-	1 505	2 166	3 015	4 081	5 393	-
60	-	-	-	-	-	-	-	-	-

Power input in W

30	-	1 386	1 678	1 974	2 262	2 531	2 768	2 964	-
35	-	1 358	1 670	1 994	2 320	2 637	2 933	3 197	-
40	-	1 322	1 650	2 001	2 363	2 725	3 076	3 405	-
45	-	-	1 620	1 994	2 389	2 794	3 197	3 589	-
50	-	-	-	1 974	2 399	2 843	3 297	3 748	-
55	-	-	-	1 941	2 393	2 875	3 375	3 883	-
60	-	-	-	-	-	-	-	-	-

Current consumption in A

30	-	2.96	3.30	3.67	4.05	4.42	4.76	5.05	-
35	-	2.93	3.27	3.67	4.09	4.52	4.93	5.31	-
40	-	2.89	3.25	3.67	4.13	4.62	5.11	5.57	-
45	-	-	3.21	3.66	4.17	4.71	5.27	5.83	-
50	-	-	-	3.63	4.18	4.78	5.41	6.06	-
55	-	-	-	3.57	4.16	4.82	5.53	6.26	-
60	-	-	-	-	-	-	-	-	-

Mass flow in kg/h

30	-	55	77	103	135	173	218	268	-
35	-	51	72	98	129	167	211	261	-
40	-	47	67	92	123	159	203	253	-
45	-	-	61	85	115	151	194	243	-
50	-	-	-	78	107	142	184	232	-
55	-	-	-	71	99	133	173	220	-
60	-	-	-	-	-	-	-	-	-

Coefficient of performance (C.O.P.)

30	-	1.22	1.44	1.69	1.99	2.33	2.74	3.23	-
35	-	1.07	1.27	1.49	1.74	2.02	2.35	2.74	-
40	-	0.93	1.10	1.29	1.51	1.74	2.02	2.33	-
45	-	-	0.95	1.11	1.29	1.49	1.72	1.97	-
50	-	-	-	0.94	1.09	1.26	1.45	1.67	-
55	-	-	-	0.78	0.91	1.05	1.21	1.39	-
60	-	-	-	-	-	-	-	-	-

Nominal performance at to = -35 °C, tc = 40 °C

Cooling capacity	1 821	W
Power input	1 650	W
Current consumption	3.25	A
Mass flow	67	kg/h
C.O.P.	1.10	

Pressure switch settings

Maximum HP switch setting	27.7	bar(g)
Minimum LP switch setting	0.1	bar(g)
LP pump down setting	0.1	bar(g)

Sound power data

Sound power level		dB(A)
With acoustic hood		dB(A)

to: Evaporating temperature at dew point

tc: Condensing temperature at dew point

Rating conditions : Superheat = 10 K , Subcooling = 0 K

Tolerance according EN12900

Performance data at 50 Hz, EN 12900 rating conditions, Suction temp. = 20 °C
R404A

Cond. temp. in °C (tc)	Evaporating temperature in °C (to)							
	-45	-40	-35	-30	-25	-20	-15	-10

Cooling capacity in W

30	-	1 852	2 597	3 540	4 706	6 123	7 814	9 806	-
35	-	-	2 308	3 192	4 287	5 620	7 216	9 101	-
40	-	-	2 002	2 819	3 837	5 080	6 574	8 346	-
45	-	-	-	2 431	3 364	4 512	5 899	7 551	-
50	-	-	-	-	2 878	3 923	5 196	6 723	-
55	-	-	-	-	-	3 323	4 476	5 871	-
60	-	-	-	-	-	2 720	3 746	5 002	-

Power input in W

30	-	1 478	1 789	2 092	2 384	2 660	2 916	3 146	-
35	-	-	1 773	2 120	2 469	2 815	3 152	3 477	-
40	-	-	1 734	2 119	2 517	2 925	3 337	3 750	-
45	-	-	-	2 089	2 531	2 994	3 475	3 968	-
50	-	-	-	-	2 511	3 024	3 566	4 133	-
55	-	-	-	-	-	3 016	3 613	4 248	-
60	-	-	-	-	-	2 974	3 619	4 314	-

Current consumption in A

30	-	2.96	3.33	3.75	4.20	4.66	5.10	5.48	-
35	-	-	3.32	3.78	4.28	4.81	5.33	5.82	-
40	-	-	3.29	3.78	4.33	4.93	5.53	6.13	-
45	-	-	-	3.76	4.36	5.01	5.70	6.40	-
50	-	-	-	-	4.35	5.07	5.84	6.64	-
55	-	-	-	-	-	5.09	5.94	6.84	-
60	-	-	-	-	-	5.08	6.01	7.00	-

Mass flow in kg/h

30	-	45	63	86	114	149	192	244	-
35	-	-	59	82	110	145	188	240	-
40	-	-	54	77	105	140	183	234	-
45	-	-	-	70	98	133	175	227	-
50	-	-	-	-	91	125	167	218	-
55	-	-	-	-	-	115	157	207	-
60	-	-	-	-	-	105	145	194	-

Coefficient of performance (C.O.P.)

30	-	1.25	1.45	1.69	1.97	2.30	2.68	3.12	-
35	-	-	1.30	1.51	1.74	2.00	2.29	2.62	-
40	-	-	1.15	1.33	1.52	1.74	1.97	2.23	-
45	-	-	-	1.16	1.33	1.51	1.70	1.90	-
50	-	-	-	-	1.15	1.30	1.46	1.63	-
55	-	-	-	-	-	1.10	1.24	1.38	-
60	-	-	-	-	-	0.91	1.04	1.16	-

Nominal performance at to = -35 °C, tc = 40 °C

Cooling capacity	2 002	W
Power input	1 734	W
Current consumption	3.29	A
Mass flow	54	kg/h
C.O.P.	1.15	



to: Evaporating temperature at dew point

tc: Condensing temperature at dew point

Rating conditions : Suction gas temp. = 20 °C , Subcooling = 0 K

Pressure switch settings

Maximum HP switch setting	27.7	bar(g)
Minimum LP switch setting	0.1	bar(g)
LP pump down setting	0.1	bar(g)

Sound power data

Sound power level	83.6	dB(A)
With acoustic hood	77.6	dB(A)

Tolerance according EN12900

Performance data at 50 Hz, EN 12900 rating conditions, Superheat = 10 K
R404A

Cond. temp. in °C (tc)	Evaporating temperature in °C (to)							
	-45	-40	-35	-30	-25	-20	-15	-10

Cooling capacity in W

30	1 122	1 647	2 343	3 237	4 363	5 750	7 430	9 437	-
35	919	1 402	2 042	2 869	3 914	5 210	6 789	8 684	-
40	-	1 152	1 731	2 483	3 442	4 639	6 108	7 884	-
45	-	906	1 417	2 090	2 955	4 047	5 399	7 047	-
50	-	673	1 111	1 697	2 463	3 442	4 669	6 183	-
55	-	-	821	1 315	1 975	2 834	3 929	5 298	-
60	-	-	-	953	1 500	2 231	3 185	4 402	-

Power input in W

30	1 165	1 478	1 789	2 092	2 384	2 660	2 916	3 146	-
35	1 099	1 431	1 773	2 120	2 469	2 815	3 152	3 477	-
40	-	1 367	1 734	2 119	2 517	2 925	3 337	3 750	-
45	-	1 289	1 673	2 089	2 531	2 994	3 475	3 968	-
50	-	1 198	1 594	2 033	2 511	3 024	3 566	4 133	-
55	-	-	1 498	1 954	2 462	3 016	3 613	4 248	-
60	-	-	-	1 854	2 384	2 974	3 619	4 314	-

Current consumption in A

30	2.67	2.96	3.33	3.75	4.20	4.66	5.10	5.48	-
35	2.66	2.94	3.32	3.78	4.28	4.81	5.33	5.82	-
40	-	2.90	3.29	3.78	4.33	4.93	5.53	6.13	-
45	-	2.83	3.24	3.76	4.36	5.01	5.70	6.40	-
50	-	2.74	3.16	3.70	4.35	5.07	5.84	6.64	-
55	-	-	3.05	3.62	4.31	5.09	5.94	6.84	-
60	-	-	-	3.51	4.24	5.08	6.01	7.00	-

Mass flow in kg/h

30	38	55	76	102	134	172	217	269	-
35	34	51	71	97	129	167	212	265	-
40	-	45	66	91	123	160	206	259	-
45	-	39	59	84	115	153	198	250	-
50	-	33	52	76	106	143	188	240	-
55	-	-	43	67	96	132	176	228	-
60	-	-	-	57	85	120	163	215	-

Coefficient of performance (C.O.P.)

30	0.96	1.11	1.31	1.55	1.83	2.16	2.55	3.00	-
35	0.84	0.98	1.15	1.35	1.59	1.85	2.15	2.50	-
40	-	0.84	1.00	1.17	1.37	1.59	1.83	2.10	-
45	-	0.70	0.85	1.00	1.17	1.35	1.55	1.78	-
50	-	0.56	0.70	0.83	0.98	1.14	1.31	1.50	-
55	-	-	0.55	0.67	0.80	0.94	1.09	1.25	-
60	-	-	-	0.51	0.63	0.75	0.88	1.02	-

Nominal performance at to = -35 °C, tc = 40 °C

Cooling capacity	1 731	W
Power input	1 734	W
Current consumption	3.29	A
Mass flow	66	kg/h
C.O.P.	1.00	

Pressure switch settings

Maximum HP switch setting	27.7	bar(g)
Minimum LP switch setting	0.1	bar(g)
LP pump down setting	0.1	bar(g)

Sound power data

Sound power level	83.6	dB(A)
With acoustic hood	77.6	dB(A)

to: Evaporating temperature at dew point

tc: Condensing temperature at dew point

Rating conditions : Superheat = 10 K , Subcooling = 0 K

Tolerance according EN12900

Performance data at 60 Hz, EN 12900 rating conditions, Suction temp. = 20 °C
R404A

Cond. temp. in °C (tc)	Evaporating temperature in °C (to)							
	-45	-40	-35	-30	-25	-20	-15	-10

Cooling capacity in W

30	-	2 258	3 271	4 485	5 919	7 595	9 531	11 748	-
35	-	-	2 840	3 993	5 353	6 941	8 777	10 881	-
40	-	-	2 395	3 482	4 765	6 262	7 993	9 980	-
45	-	-	-	2 961	4 161	5 563	7 186	9 051	-
50	-	-	-	-	3 549	4 851	6 362	8 101	-
55	-	-	-	-	-	4 135	5 529	7 138	-
60	-	-	-	-	-	3 421	4 694	6 169	-

Power input in W

30	-	1 739	2 167	2 575	2 947	3 266	3 514	3 676	-
35	-	-	2 130	2 598	3 045	3 452	3 803	4 082	-
40	-	-	2 062	2 587	3 104	3 596	4 047	4 440	-
45	-	-	-	2 537	3 122	3 696	4 243	4 746	-
50	-	-	-	-	3 096	3 749	4 389	4 999	-
55	-	-	-	-	-	3 751	4 480	5 194	-
60	-	-	-	-	-	3 699	4 515	5 329	-

Current consumption in A

30	-	2.92	3.33	3.75	4.18	4.62	5.06	5.51	-
35	-	-	3.34	3.82	4.31	4.80	5.29	5.78	-
40	-	-	3.30	3.85	4.41	4.96	5.52	6.07	-
45	-	-	-	3.82	4.46	5.10	5.73	6.36	-
50	-	-	-	-	4.45	5.19	5.91	6.62	-
55	-	-	-	-	-	5.21	6.04	6.86	-
60	-	-	-	-	-	5.16	6.11	7.05	-

Mass flow in kg/h

30	-	55	79	109	144	186	235	293	-
35	-	-	72	102	137	179	229	287	-
40	-	-	65	94	130	172	222	280	-
45	-	-	-	86	121	164	214	272	-
50	-	-	-	-	112	154	204	263	-
55	-	-	-	-	-	144	194	252	-
60	-	-	-	-	-	131	182	240	-

Coefficient of performance (C.O.P.)

30	-	1.30	1.51	1.74	2.01	2.33	2.71	3.20	-
35	-	-	1.33	1.54	1.76	2.01	2.31	2.67	-
40	-	-	1.16	1.35	1.54	1.74	1.98	2.25	-
45	-	-	-	1.17	1.33	1.50	1.69	1.91	-
50	-	-	-	-	1.15	1.29	1.45	1.62	-
55	-	-	-	-	-	1.10	1.23	1.37	-
60	-	-	-	-	-	0.92	1.04	1.16	-

Nominal performance at to = -35 °C, tc = 40 °C

Cooling capacity	2 395	W
Power input	2 062	W
Current consumption	3.30	A
Mass flow	65	kg/h
C.O.P.	1.16	

Pressure switch settings

Maximum HP switch setting	27.7	bar(g)
Minimum LP switch setting	0.1	bar(g)
LP pump down setting	0.1	bar(g)

Sound power data

Sound power level	84.2	dB(A)
With acoustic hood	77	dB(A)

to: Evaporating temperature at dew point

tc: Condensing temperature at dew point

Rating conditions : Suction gas temp. = 20 °C , Subcooling = 0 K

Tolerance according EN12900

Performance data at 60 Hz, EN 12900 rating conditions, Superheat = 10 K
R404A

Cond. temp. in °C (tc)	Evaporating temperature in °C (to)							
	-45	-40	-35	-30	-25	-20	-15	-10

Cooling capacity in W

30	1 249	2 008	2 951	4 102	5 487	7 132	9 063	11 306	-
35	921	1 631	2 512	3 589	4 888	6 435	8 258	10 382	-
40	-	1 256	2 070	3 068	4 275	5 719	7 427	9 427	-
45	-	892	1 633	2 545	3 655	4 989	6 577	8 447	-
50	-	548	1 210	2 031	3 037	4 256	5 717	7 450	-
55	-	-	812	1 535	2 430	3 526	4 853	6 443	-
60	-	-	-	1 066	1 842	2 807	3 991	5 429	-

Power input in W

30	1 308	1 739	2 167	2 575	2 947	3 266	3 514	3 676	-
35	1 193	1 656	2 130	2 598	3 045	3 452	3 803	4 082	-
40	-	1 545	2 062	2 587	3 104	3 596	4 047	4 440	-
45	-	1 402	1 958	2 537	3 122	3 696	4 243	4 746	-
50	-	1 226	1 818	2 447	3 096	3 749	4 389	4 999	-
55	-	-	1 636	2 312	3 023	3 751	4 480	5 194	-
60	-	-	-	2 131	2 899	3 699	4 515	5 329	-

Current consumption in A

30	2.51	2.92	3.33	3.75	4.18	4.62	5.06	5.51	-
35	2.39	2.87	3.34	3.82	4.31	4.80	5.29	5.78	-
40	-	2.74	3.30	3.85	4.41	4.96	5.52	6.07	-
45	-	2.53	3.18	3.82	4.46	5.10	5.73	6.36	-
50	-	2.21	2.97	3.71	4.45	5.19	5.91	6.62	-
55	-	-	2.65	3.52	4.37	5.21	6.04	6.86	-
60	-	-	-	3.21	4.19	5.16	6.11	7.05	-

Mass flow in kg/h

30	43	67	96	129	168	213	265	323	-
35	34	59	88	122	161	206	258	316	-
40	-	49	79	113	152	198	250	309	-
45	-	39	68	102	142	188	241	300	-
50	-	27	56	91	131	177	230	290	-
55	-	-	43	78	118	165	218	278	-
60	-	-	-	63	104	151	205	265	-

Coefficient of performance (C.O.P.)

30	0.96	1.15	1.36	1.59	1.86	2.18	2.58	3.08	-
35	0.77	0.98	1.18	1.38	1.61	1.86	2.17	2.54	-
40	-	0.81	1.00	1.19	1.38	1.59	1.84	2.12	-
45	-	0.64	0.83	1.00	1.17	1.35	1.55	1.78	-
50	-	0.45	0.67	0.83	0.98	1.14	1.30	1.49	-
55	-	-	0.50	0.66	0.80	0.94	1.08	1.24	-
60	-	-	-	0.50	0.64	0.76	0.88	1.02	-

Nominal performance at to = -35 °C, tc = 40 °C

Cooling capacity	2 070	W
Power input	2 062	W
Current consumption	3.30	A
Mass flow	79	kg/h
C.O.P.	1.00	

Pressure switch settings

Maximum HP switch setting	27.7	bar(g)
Minimum LP switch setting	0.1	bar(g)
LP pump down setting	0.1	bar(g)

Sound power data

Sound power level	84.2	dB(A)
With acoustic hood	77	dB(A)

to: Evaporating temperature at dew point

tc: Condensing temperature at dew point

Rating conditions : Superheat = 10 K , Subcooling = 0 K

Tolerance according EN12900