



OIL LEVEL REGULATORS

- Provide permanent control over oil coming to compressor in multiple parallel compressor systems.
- Completely eliminates risk of recycling of liquid resulting from compressor.
- Used between oil reservoir and compressor, and directly mounted to compressor's carter.
- Produced in 2 different models; fixed and adjustable.
- The products are designed for 3-bolt & 4-bolt flange systems.
- The product operates with buoy system.
- Oil level can be easily followed thanks to sight glasses provided in the product.
- We strongly recommend using oil filters together with oil level regulators.
- Can be easily mounted to compressors thanks to flange connection suitable for any type of compressor.
- Adapters especially designed for compressors with different connections can be seen on page 38.
- Deep drawn body is used in our products.
- Color [RAL] 5009

YAĞ SEVİYE REGÜLATÖRLERİ

- Çoklu paralel kompresör sistemlerinde, kompresöre giden yağın devamlı olarak kontrollü gitmesini sağlamaktadır.
- Kompresörden kaynaklanacak sıvının geri dönüşüm riskini tamamen ortadan kaldırmaktadır.
- Yağ deposu ile kompresör arasında kullanılmaktadır ve direkt olarak kompresör karterine montaj edilmektedir.
- Sabit ve Ayarlanabilir olarak 2 farklı model olarak üretilmektedir.
- Ürünler 3 cıvatalı & 4 cıvatalı flanş sistemlerine uygun olarak tasarlanmıştır.
- Şamandıra sistemli çalışan bir üründür.
- Ürün üzerinde bulunan Gözetleme camları sayesinde yağ seviyesi kolaylıkla takip edilebilmektedir.
- Yağ seviye regülâtörleri ile birlikte yağ filtrelerinin kullanılmasını önemle tavsiye etmekteyiz.
- Her tür kompresör bağlantısına uygun flanş bağlantısı ile kompresörlere kolaylıkla montajlanabilmektedir.
- Farklı bağlantılı kompresörler için özel tasarlanmış adaptörler ile ilgili sayfa 38'i inceleyebilirsiniz.
- Ürünlerimizde derin sıvama gövde kullanılmaktadır.
- Renk [RAL] 5009

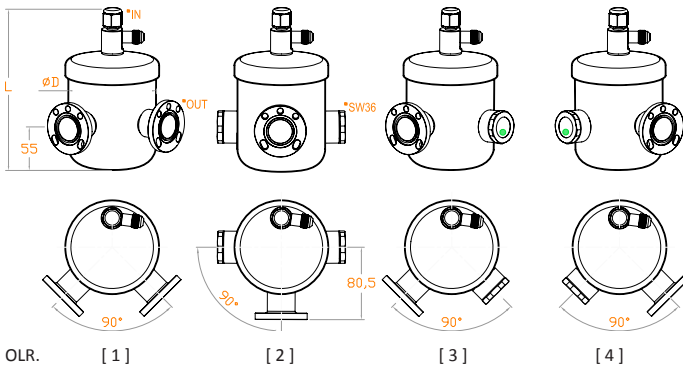

OLR SERIES
SERİSİ

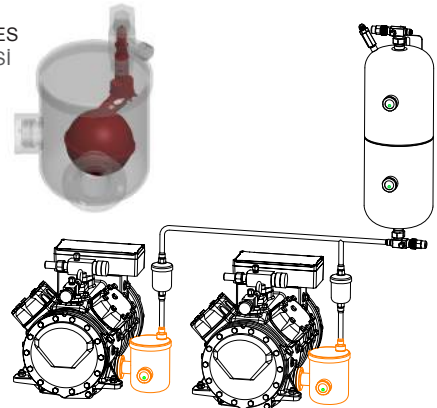

Model	D [mm]	L [mm]	Connections			Regulator Type	Allow. Oil Pressure Diff. [bar]	Allowable Operating Pressure	Allowable Operating Temperature	CE 97/23/EC 33 Bar
			1 [mm]	2 [mm]	3 [mm]					
OLR.1	ø 102	156,5	3/8" SAE Flare Inlet	3 Bolt 1.7/8" B.C. & 4 Bolt 50mm B.C.	-	Fixed	0.35 to 2.1	0 to 31 bar	0° C to + 110° C	SEP
OLR.2.H2					2x SW36					
OLR.3.H1					1x SW36					
OLR.4.H1					1x SW36					
OLR.A.1	ø 102	174,5	3/8" SAE Flare Inlet	3 Bolt 1.7/8" B.C. & 4 Bolt 50mm B.C.	-	Adjustable	0.35 to 6.2	0 to 31 bar	0° C to + 110° C	SEP
OLR.A.2.H2					2x SW36					
OLR.A.3.H1					1x SW36					
OLR.A.4.H1					1x SW36					

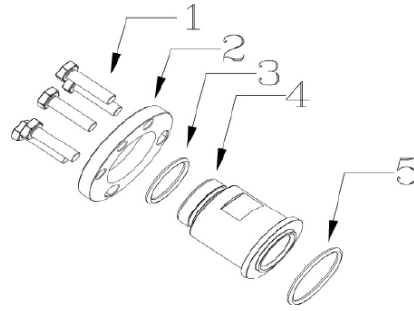

Model	Dimensions				
	1	2	3	4	5
OLR-ADP-10A	M8.8	3 Bolt 1.7/8" B.C. & 4 Bolt 50mm B.C.3,8	O ring	Thread 1 1/8"-12UNF	O ring
OLR-ADP-10B	M8.8	3 Bolt 1.7/8" B.C. & 4 Bolt 50mm B.C.3,8	O ring	Thread 1 1/8"-18UNEF	O ring

Compressors Adapter Kits List

Manufacturer	Compressor		Compressor Connections	Adapter Kit Models
	Model			
BITZER	From 2 CC up to 2 KC		1.1/8" - 18UNEF Thread	OLR-ADP-10B
	From 4 CC up to 4 FC		1.1/8" - 18UNEF Thread	OLR-ADP-10B
	ESH		1.1/8" - 18UNEF Thread	OLR-ADP-10B
	From 4 NC up to 4 VC		3 Bolts, 1.7/8" B.C	Not Necessary
	6D - 6E		3 Bolts, 1.7/8" B.C	Not Necessary
	8 FC - 8 GC		3 Bolts, 1.7/8" B.C	-
	2 H - 2 T - 4 H - 4 T - 4P		4 Bolts, 50 mm B.C	Not Necessary
	4 G - 4 H - 4 J - 6 F - 6 G - 6 H - 6 J		4 Bolts, 50 mm B.C	Not Necessary
S 4 - S 6		4 Bolts, 50 mm B.C	Not Necessary	
BOCK	HA From 3 up to 5		3 Bolts, 1.7/8" B.C	Not Necessary
	HG From 3 up to 5		3 Bolts, 1.7/8" B.C	Not Necessary
	HG 7 & HG 8		3 Bolts, 1.7/8" B.C	Not Necessary
	AM From 2 up to 5		4 Bolts, 50 mm B.C	-
	F From 2 up to 16		4 Bolts, 50 mm B.C	-
	HA12, 22, 34 / HG 12, 22, 34		1.1/8" - 18UNEF Thread	OLR-ADP-10B
CARRIER	EA, ER, 6E, OBE, OBCC		3 Bolts, 1.7/8" B.C	Not Necessary
COPELAND	D2, D3, D4, D6, 4CC, 6CC		3 Bolts, 1.7/8" B.C	Not Necessary
	D8, 8CC		3 Bolts, 1.7/8" B.C	-
	DK, DL, DN, ZR, ZZ		1.1/8" - 12UNEF Thread	OLR-ADP-10A
DORIN	K, KP, 2S, Y		3 Bolts, 1.7/8" B.C	Not Necessary
	H From 40CC up to 240SB		1.1/8" - 18UNEF Thread	OLR-ADP-10B
	K From 400CC up to 240SB		1.1/8" - 18UNEF Thread	OLR-ADP-10B
DUNHAM BUSH	BIG 4		3 Bolts, 1.7/8" B.C	Not Necessary
FRASCOLD	ALL		3 Bolts, 1.7/8" B.C	Not Necessary
MANEUROP	ALL		1.1/8" - 18UNEF Thread	OLR-ADP-10B
REFCOMP	L, OF, SP		3 Bolts, 1.7/8" B.C	-
TECUMSEH	P, R, S, PA, RA, SA, CK, CM, CH, CG		1.1/8" - 12UNEF Thread	OLR-ADP-10A
	TAG, TAH		1.1/8" - 18UNEF Thread	OLR-ADP-10B
TRANE	M, R		3 Bolts, 1.7/8" B.C	Not Necessary
YORK	GC, GS, JS		3 Bolts, 1.7/8" B.C	Not Necessary