

AG Hermetic Compressors

Information Package



Tecumseh



AG Hermetic Compressors
Information Package

AG Information Package

AG Compressor Range and Performances	3
Why a new AG?	4
AG Product Description Nomenclature – Tecumseh Europe	6
AG Technical Data HP R-404A	7
AG Technical Data LBP R-404A	9
Technical data sheet HP R22	13
AG Outlines Drawings.....	15
AG Benchmark Positive Refrigeration	16
AG Benchmark Negative Refrigeration	19
AG Benchmark.....	21
TAG2525Z / NTZ136	21
Cooling capacity comparison : TAG and NTZ have similar capacity	21
Efficiency comparison : TAG compresseur is better than NTZ of 3 to 7%.....	21
AG Multiple and Unitary Packaging.....	22
Marketing Tools.....	23



AG Compressor Range and Performances

R-404A COMMERCIAL POSITIVE REFRIGERATION

Models	Displacement (cm ³)	Cooling capacity (Watt) EN12900 condensing T° +45°C, Subcooling 0K, RGT 20°C							EN12900 evaporating T° -10°C		Tubing diameter (mm - inches)			Voltage available	Weight Kg	Height mm
		Evaporating T°							Power input W	COP W/W	Suction	Discharge	Process			
		-15°C	-10°C	-5°C	0°C	5°C	10°C	15°C								
TAG4546Z	90	4035	5457	7122	9061	11307	13892	16850	2949	1,85	22,2 - 7/8"	15,9 - 5/8"	9,5 - 3/8"	KZ, TZ	43	368
TAG4553Z	101	4633	6220	8062	10202	12684	15550	18845	3354	1,85	22,2 - 7/8"	15,9 - 5/8"	9,5 - 3/8"	KZ, TZ	45	381
TAG4561Z	112	5389	7107	9082	11363	13998	17036	20527	3782	1,88	28,6 - 1"1/8"	15,9 - 5/8"	9,5 - 3/8"	KZ, TZ	46	381
TAG4568Z	124	6533	8477	10702	13253	16166	19510	23305	4223	2,01	28,6 - 1"1/8"	15,9 - 5/8"	9,5 - 3/8"	KZ, TZ	47	393
TAG4573Z	135	7121	9156	11508	14224	17358	20938	25033	4681	1,96	28,6 - 1"1/8"	15,9 - 5/8"	9,5 - 3/8"	KZ, TZ	49	393
NEW TAG4581Z*	145	7960	10125	12577	15364	18536	22139	26223	5462	1,85	28,6 - 1"1/8"	15,9 - 5/8"	9,5 - 3/8"	TZ	49	393

TAG4581T is available with R-22 refrigerant.

R-404A COMMERCIAL NEGATIVE REFRIGERATION

Models	Displacement (cm ³)	Cooling capacity (Watt) EN12900 condensing T° +40°C, Subcooling 0K, RGT 20°C						EN12900 evaporating T° -35°C		Tubing diameter (mm - inches)			Voltage available	Weight Kg	Height mm
		Evaporating T°						Power input W	COP W/W	Suction	Discharge	Process			
		-35°C	-30°C	-25°C	-20°C	-15°C	-10°C								
NEW TAG2513Z*	101	1534	2358	3367	4585	6035	7740	1631	0,95	22,2 - 7/8"	15,9 - 5/8"	9,5 - 3/8"	TZ	44	368
TAG2516Z	112	2341	3149	4218	5512	7061	8851	2106	1,11	22,2 - 7/8"	15,9 - 5/8"	9,5 - 3/8"	KZ, TZ	44	368
TAG2522Z	135	2685	3793	5136	6747	8661	10914	2389	1,12	28,6 - 1"1/8"	15,9 - 5/8"	9,5 - 3/8"	KZ, TZ	47	381
NEW TAG2525Z*	145	3607	4653	6048	7803	9909	12387	3164	1,14	28,6 - 1"1/8"	15,9 - 5/8"	9,5 - 3/8"	TZ	47	381

Why a new AG?

The AG range is expanding with 3 new models to offer more cooling capacity in the same dimension:

NEW	TAG4581Z	Positive refrigeration
NEW	TAG2513Z	Negative refrigeration
NEW	TAG2525Z	Negative refrigeration



NEW AG BOM

TAG4581Z -TZ → 2836330102

TAG4581T -TZ → 2831130102

TAG2513Z -TZ → 2835330102

TAG2525Z -TZ → 2835530102

DESIGN IMPROVEMENTS

1. Increase displacement of 135cc to 145cc
2. Decrease dead volume → thanks to valve plate and piston new design
3. New motor design



Why a new AG?

They are designed and assembled based on the values that built the reputation of the AG range. This family is well-known on the market for its reliability and durability.

Reliability for demanding applications

These compressors are world-renowned for their reliability and ability to operate in demanding or difficult applications (hot gas defrosting on ice-making machine, or pull-down with start-up outside the evaporating range on milk tanks). AG compressors are a benchmark on the commercial refrigeration market.

Modularity for greater competitiveness

AG compressors are suited to refrigerating systems with large power variations, which can operate on a rack. TAGP compressors are equipped as standard with an oil sight glass indicator, and an oil equalization connector equalizer coupling so that they can be installed quickly and easily on the central plant, to boost and modulate the power.



Guaranteed Performance

As an active member of Asercom, Tecumseh guarantees the refrigeration performance level and energy efficiency level of its AG compressors. To this end Tecumseh offers reliable and transparent information to customers and users, to reinforce trust in the solutions it provides. For its customers, this is also a competitive advantage in winning the trust of their own customers.

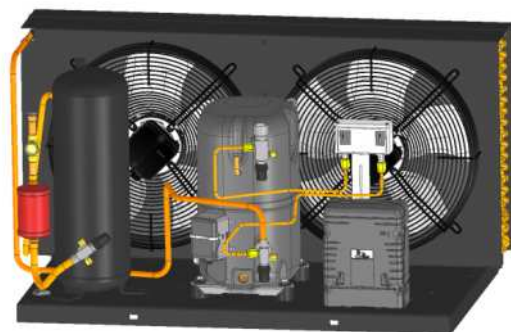

AG Product Description Nomenclature – Tecumseh Europe

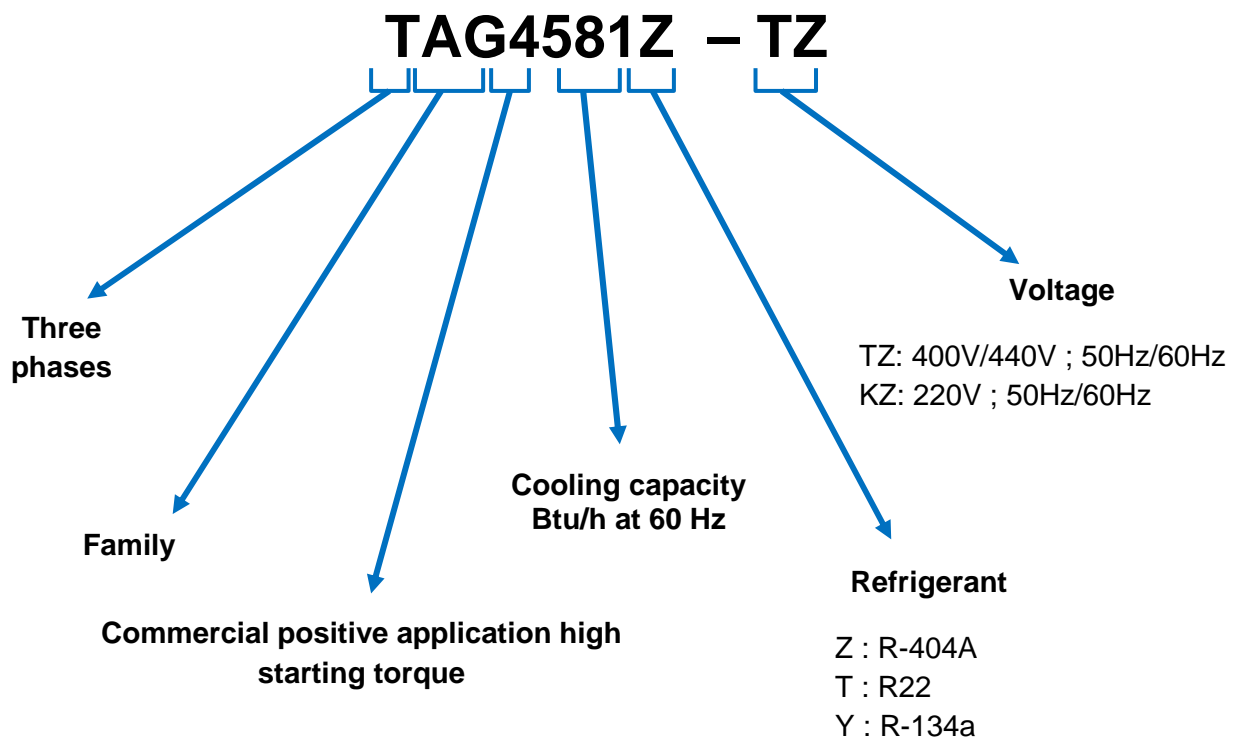

AG Technical Data HP R-404A

Compresseur / Compressor
Code tension / Voltage code : T

TAG4581Z

Froid commercial et industriel positif (HP)
Commercial & industrial application (HBP)

400-440V / 50-60Hz - 3~

R404A

N° 227MU-T - ind b

Conditions <i>Conditions</i>	fréquence <i>frequency</i>	Prod frigorifique nominale / <i>nominal refrigerating capacity</i>			Puis. sonore <i>Sound level</i>
		Watts	Kcal/h	BTU/h	
EN12900*	50 Hz	16569	14249	56500	ISO 3745 / ISO 3743-1 84 dBA
EN12900*	60 Hz	19419	16700	66219	
Cecomaf	50 Hz	15853			
Cecomaf	60 Hz	18728			

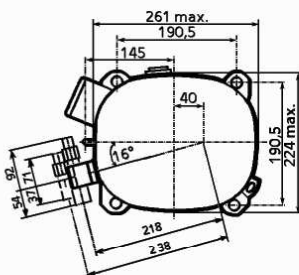
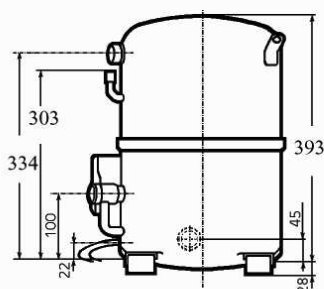

* EN 12900: T°cond.+50°C / T°évap. +5°C / T°gas aspirés. +20°C / Sous refroidissement. 0K

* EN 12900 : Cond. T° +50°C / Evap. T° +5°C / Return gas T° +20°C / Subcooling. 0K

Cylindrée / *Displacement* : 145 cm³
Poids net / *Net weight* : 48.1 Kg
Charge en huile / *Oil charge* : 1960 cm³
Type d'huile / *Oil type* : P.O.E /
Détente / *Expansion device* : Capillaire/Détendeur
Capillary/Exp° valve
Refroidissement / *Cooling* : Ventilé / *Forced*

Résistance à 20° C / *Windings resistances at 20° C*
Phases 1,2,3. / *Phase Nr 1,2,3* : 1.63 Ohms

Intensité / *Current*
nom. / *Rated current RLA* : 12.7 / 13.9 A
max. / *Max current* : 20.8 / 21.4 A
dém. / *Start current LRA* : 83 / 85 A

Ap. Electrique / *Electrical equipment* : TRI

Protecteur / *Overload* : Interne / *Internal*

Pour conduites Ø ext / *For tubing O.D.*

Aspiration <i>Suction</i>	Refolement <i>Discharge</i>	Charge <i>Process</i>
28.6 (1"1/8)	15.9 (5/8")	6.35 (1/4")

Les caractéristiques données dans cette fiche technique peuvent évoluer sans avis préalable, avec les améliorations que 'TECUMSEH EUROPE' entend toujours apporter à sa production.
'TECUMSEH EUROPE', in a constant endeavour to improve its products reserves the right to change any information contained in this leaflet without prior warning.



TAG4581Z	Tension T : 400V 3~ 50Hz / 440V 3~ 60 Hz	R404A	N°227MU-T	Ind a
-----------------	---	--------------	------------------	--------------

Les performances sont données dans les **conditions EN 12900** : Gaz aspirés : 20°C
 Sous refroidissement : 0°K

The performance data are in **EN 12900 conditions** : Return gas : 20°C
 Subcooling : 0°K

50 Hz R404A

4 T condensation	5 T évaporation	(°C)	-25	-20	-15	-10	-5	0	5	10	15
30	1 P frigorigère	(W)	6540	8504	10797	13470	16568	20141	24237	28904	34190
	2 P absorbée	(W)	3573	4078	4549	5003	5454	5919	6413	6954	7556
	3 I absorbée	(A)	7.16	7.65	8.17	8.72	9.3	9.91	10.55	11.21	11.91
40	1 P frigorigère	(W)		6881	8931	11267	13937	16989	20471	24431	28918
	2 P absorbée	(W)		4186	4779	5334	5867	6393	6929	7491	8094
	3 I absorbée	(A)		7.8	8.44	9.11	9.82	10.55	11.31	12.09	12.91
50	1 P frigorigère	(W)			6966	8957	11189	13710	16569	19814	23492
	2 P absorbée	(W)			4867	5558	6206	6828	7439	8056	8694
	3 I absorbée	(A)			8.63	9.42	10.25	11.1	11.98	12.9	13.84
60	1 P frigorigère	(W)				6557	8341	10323	12549	15069	17929
	2 P absorbée	(W)				5631	6429	7181	7901	8607	9314
	3 I absorbée	(A)				9.65	10.6	11.58	12.58	13.62	14.68

60 Hz R404A

4 T condensation	5 T évaporation	(°C)	-25	-20	-15	-10	-5	0	5	10	15
30	1 P frigorigère	(W)	7739	10013	12607	15580	18990	22898	27360	32438	38189
	2 P absorbée	(W)	4335	4964	5575	6193	6843	7549	8335	9227	10250
	3 I absorbée	(A)	6.89	7.62	8.38	9.17	9.99	10.83	11.71	12.62	13.55
40	1 P frigorigère	(W)		8245	10625	13290	16299	19712	23586	27981	32957
	2 P absorbée	(W)		5130	5869	6581	7293	8028	8810	9666	10618
	3 I absorbée	(A)		7.79	8.68	9.59	10.54	11.51	12.51	13.54	14.6
50	1 P frigorigère	(W)			8435	10747	13308	16180	19419	23086	27239
	2 P absorbée	(W)			6004	6876	7714	8542	9386	10268	11215
	3 I absorbée	(A)			8.9	9.94	11.01	12.11	13.24	14.4	15.58
60	1 P frigorigère	(W)				8037	10105	12388	14947	17838	21123
	2 P absorbée	(W)				6960	7989	8975	9943	10918	11923
	3 I absorbée	(A)				10.21	11.41	12.63	13.89	15.17	16.49

1 = refrigerating capacity 2 = watt input 3 = current 4 = condensing temperature 5 = evaporating temperature

Nota : Les caractéristiques données dans cette fiche technique peuvent évoluer sans avis préalable, avec les améliorations que "TECUMSEH EUROPE" entend toujours apporter à sa production.

Note : "TECUMSEH EUROPE", in a constant endeavour to improve its products reserves the right to change any information contained in this leaflet without prior warning.



AG Technical Data LBP R-404A

Compresseur / *Compressor*
Code tension / *Voltage code* : T

TAG2513Z

Froid commercial négatif (BP)
Low back pressure commercial application

400-440V / 50-60Hz - 3~

R404A

N° 127DU-T - ind a

Conditions <i>Conditions</i>	fréquence <i>frequency</i>	Prod frigorifique nominale / <i>nominal refrigerating capacity</i>			Puis. sonore <i>Sound level</i>
		Watts	Kcal/h	BTU/h	
EN12900*	50 Hz	1534	1319	5231	ISO 3745 / ISO 3743-1
EN12900*	60 Hz	1910	1643	6513	
Cecomaf	50 Hz	2087			
Cecomaf	60 Hz	2584			

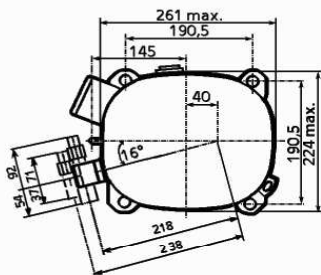
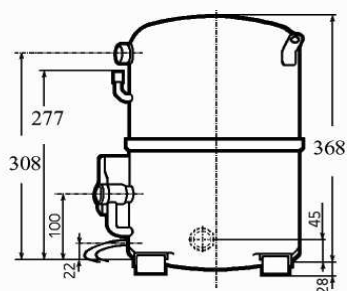

* EN12900: T° cond. +40°C / T° évap. -35°C / T° gas aspirés. +20°C / Sous refroidissement. OK

* EN 12900 : Cond. T° +40°C / Evap. T° -35°C / Return gas T° +20°C / Subcooling. OK

Cylindrée / *Displacement* : 100.7 cm³
Poids net / *Net weight* : 44 Kg
Charge en huile / *Oil charge* : 1960 cm³
Type d'huile / *Oil type* : P.O.E /
Détente / *Expansion device* : Capillaire/Détendeur
Capillary/Exp° valve
Refroidissement / *Cooling* : Ventilé / *Forced*

Résistance à 20° C / *Windings resistances at 20° C*
Phases 1,2,3. / *Phase Nr 1,2,3* : 4.6 Ohms

Intensité / *Current*
nom. / *Rated current RLA* : 4.2 / 4.3 A
max. / *Max current* : 8.5 / 8.9 A
dém. / *Start current LRA* : 42 / 42.5 A

Ap. Electrique / *Electrical equipment* : TRI

Protecteur / *Overload* : Interne / *Internal*

Pour conduites Ø ext / *For tubing O.D.*

Aspiration <i>Suction</i>	Refoulement <i>Discharge</i>	Charge <i>Process</i>
22.2 (7/8")	15.9 (5/8")	6.35 (1/4")

Les caractéristiques données dans cette fiche technique peuvent évoluer sans avis préalable, avec les améliorations que 'TECUMSEH EUROPE' entend toujours apporter à sa production.
'TECUMSEH EUROPE', in a constant endeavour to improve its products reserves the right to change any information contained in this leaflet without prior warning.



TAG2513Z	Tension T : 400V 3~ 50Hz / 440V 3~ 60 Hz	R404A	N°127DU-T	Ind a
-----------------	---	--------------	------------------	--------------

Les performances sont données dans les **conditions EN 12900** : Gaz aspirés : 20°C
 Sous refroidissement : 0°K

The performance data are in **EN 12900 conditions** : Return gas : 20°C
 Subcooling : 0°K

50 Hz R404A

4 T condensation	5 T évaporation	(°C)	-40	-35	-30	-25	-20	-15	-10
30	1 P frigorigère	(W)	1428	2212	3194	4399	5848	7565	9573
	2 P absorbée	(W)	1387	1755	2125	2498	2876	3257	3643
	3 I absorbée	(A)	3.36	3.71	4.09	4.52	4.99	5.5	6.04
40	1 P frigorigère	(W)	872	1534	2358	3367	4585	6035	7740
	2 P absorbée	(W)	1213	1631	2057	2492	2937	3392	3858
	3 I absorbée	(A)	3.13	3.55	4.02	4.52	5.06	5.65	6.27
50	1 P frigorigère	(W)		912	1578	2393	3381	4565	5967
	2 P absorbée	(W)		1414	1896	2393	2905	3433	3978
	3 I absorbée	(A)		3.29	3.84	4.42	5.04	5.7	6.4
60	1 P frigorigère	(W)			882	1504	2262	3181	4282
	2 P absorbée	(W)			1628	2186	2765	3366	3990
	3 I absorbée	(A)			3.56	4.21	4.91	5.65	6.43

60 Hz R404A

4 T condensation	5 T évaporation	(°C)	-40	-35	-30	-25	-20	-15	-10
30	1 P frigorigère	(W)	1810	2769	3923	5292	6899	8763	10907
	2 P absorbée	(W)	1717	2170	2600	3026	3465	3935	4455
	3 I absorbée	(A)	3.22	3.66	4.13	4.64	5.18	5.77	6.39
40	1 P frigorigère	(W)	1050	1910	2932	4137	5547	7182	9065
	2 P absorbée	(W)	1421	1993	2533	3061	3594	4149	4746
	3 I absorbée	(A)	2.87	3.43	4.03	4.67	5.35	6.06	6.8
50	1 P frigorigère	(W)		1063	1941	2970	4171	5566	7175
	2 P absorbée	(W)		1626	2295	2943	3587	4247	4939
	3 I absorbée	(A)		3.03	3.76	4.52	5.33	6.16	7.04
60	1 P frigorigère	(W)			1002	1842	2822	3964	5288
	2 P absorbée	(W)			1856	2642	3416	4198	5004
	3 I absorbée	(A)			3.3	4.2	5.13	6.09	7.1

1 = refrigerating capacity 2 = watt input 3 = current 4 = condensing temperature 5 = evaporating temperature

Nota : Les caractéristiques données dans cette fiche technique peuvent évoluer sans avis préalable, avec les améliorations que "TECUMSEH EUROPE" entend toujours apporter à sa production.

Note : "TECUMSEH EUROPE", in a constant endeavour to improve its products reserves the right to change any information contained in this leaflet without prior warning.



Compresseur / Compressor
Code tension / Voltage code : T

TAG2525Z

Froid commercial négatif (BP)
Low back pressure commercial application

400-440V / 50-60Hz - 3~

R404A

N° 127MU-T - ind b

Conditions <i>Conditions</i>	fréquence <i>frequency</i>	Prod frigorifique nominale / <i>nominal refrigerating capacity</i>			Puis. sonore <i>Sound level</i>
		Watts	Kcal/h	BTU/h	
EN12900*	50 Hz	3012	2590	10271	ISO 3745 / ISO 3743-1
EN12900*	60 Hz	3802	3270	12965	
Cecomaf	50 Hz	4008			84 dBA
Cecomaf	60 Hz	5041			

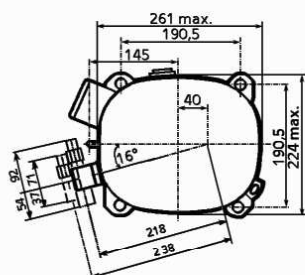
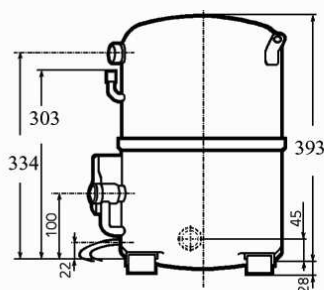

* EN12900: T° cond. +40°C / T° évap. -35°C / T° gas aspirés. +20°C / Sous refroidissement. OK

* EN 12900 : Cond. T° +40°C / Evap. T° -35°C / Return gas T° +20°C / Subcooling. OK

Cylindrée / *Displacement* : 145 cm³
Poids net / *Net weight* : 46 Kg
Charge en huile / *Oil charge* : 1960 cm³
Type d'huile / *Oil type* : P.O.E /
Détente / *Expansion device* : Capillaire/Détendeur
Capillary/Exp° valve
Refroidissement / *Cooling* : Ventilé / *Forced*

Résistance à 20° C / *Windings resistances at 20° C*
Phases 1,2,3. / *Phase Nr 1,2,3* : 2.9 Ohms

Intensité / *Current*
nom. / *Rated current RLA* : 6.3 / 6.9 A
max. / *Max current* : 13.3 / 13.3 A
dém. / *Start current LRA* : 56 / 58 A

Ap. Electrique / *Electrical equipment* : TRI

Protecteur / *Overload* : Interne / *Internal*

Pour conduites Ø ext / *For tubing O.D.*

Aspiration <i>Suction</i>	Refolement <i>Discharge</i>	Charge <i>Process</i>
28.6 (1"1/8")	15.9 (5/8")	6.35 (1/4")

Les caractéristiques données dans cette fiche technique peuvent évoluer sans avis préalable, avec les améliorations que 'TECUMSEH EUROPE' entend toujours apporter à sa production.
'TECUMSEH EUROPE', in a constant endeavour to improve its products reserves the right to change any information contained in this leaflet without prior warning.



TAG2525Z	Tension T : 400V 3~ 50Hz / 440V 3~ 60 Hz	R404A	N°127MU-T	Ind b
-----------------	---	--------------	------------------	--------------

Les performances sont données dans les **conditions EN 12900** : Gaz aspirés : 20°C
 Sous refroidissement : 0°K

The performance data are in **EN 12900 conditions** : Return gas : 20°C
 Subcooling : 0°K

50 Hz R404A

4 T condensation	5 T évaporation	(°C)	-40	-35	-30	-25	-20	-15	-10
30	1 P frigorifique	(W)	2763	3929	5329	6989	8934	11192	13788
	2 P absorbée	(W)	2204	2706	3222	3753	4301	4866	5449
	3 I absorbée	(A)	4.7	5.23	5.82	6.47	7.19	7.98	8.83
40	1 P frigorifique	(W)	1984	3012	4230	5665	7342	9288	11529
	2 P absorbée	(W)	2097	2659	3240	3841	4464	5109	5776
	3 I absorbée	(A)	4.58	5.2	5.89	6.64	7.45	8.34	9.28
50	1 P frigorifique	(W)		2132	3159	4358	5757	7381	9256
	2 P absorbée	(W)		2536	3182	3853	4549	5273	6024
	3 I absorbée	(A)		5.04	5.83	6.68	7.59	8.57	9.61
60	1 P frigorifique	(W)			2140	3094	4204	5495	6995
	2 P absorbée	(W)			3049	3789	4559	5360	6194
	3 I absorbée	(A)			5.65	6.6	7.61	8.68	9.82

60 Hz R404A

4 T condensation	5 T évaporation	(°C)	-40	-35	-30	-25	-20	-15	-10
30	1 P frigorifique	(W)	3451	4814	6404	8248	10369	12792	15542
	2 P absorbée	(W)	2772	3390	4008	4640	5297	5990	6732
	3 I absorbée	(A)	4.67	5.4	6.17	6.96	7.79	8.64	9.53
40	1 P frigorifique	(W)	2532	3802	5255	6915	8808	10959	13391
	2 P absorbée	(W)	2611	3349	4082	4821	5577	6362	7189
	3 I absorbée	(A)	4.44	5.33	6.25	7.21	8.19	9.21	10.26
50	1 P frigorifique	(W)		2707	3996	5449	7088	8940	11029
	2 P absorbée	(W)		3123	3991	4857	5734	6633	7566
	3 I absorbée	(A)		5.04	6.12	7.23	8.38	9.56	10.76
60	1 P frigorifique	(W)			2670	3889	5250	6779	8500
	2 P absorbée	(W)			3690	4706	5724	6759	7819
	3 I absorbée	(A)			5.76	7.04	8.34	9.68	11.05

1 = refrigerating capacity 2 = watt input 3 = current 4 = condensing temperature 5 = evaporating temperature

Nota : Les caractéristiques données dans cette fiche technique peuvent évoluer sans avis préalable, avec les améliorations que "TECUMSEH EUROPE" entend toujours apporter à sa production.

Note : "TECUMSEH EUROPE", in a constant endeavour to improve its products reserves the right to change any information contained in this leaflet without prior warning.

Technical data sheet HP R22

Compresseur / *Compressor*
Code tension / *Voltage code* : T

TAG4581T

Froid commercial et industriel positif (HP)
Commercial & industrial application (HBP)

400-440V / 50-60Hz - 3~

R22

N° 237MU-T - ind a

Conditions <i>Conditions</i>	fréquence <i>frequency</i>	Prod frigorifique nominale / <i>nominal refrigerating capacity</i>			Puis. sonore <i>Sound level</i>
		Watts	Kcal/h	BTU/h	
EN12900*	50 Hz	17152	14751	58488	ISO 3745 / ISO 3743-1
EN12900*	60 Hz	20290	17449	69189	
Cecomaf	50 Hz	16326			82 dBA
Cecomaf	60 Hz	19339			

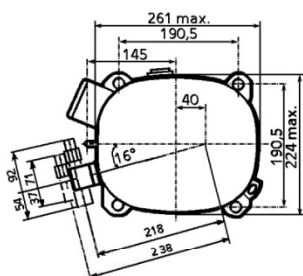
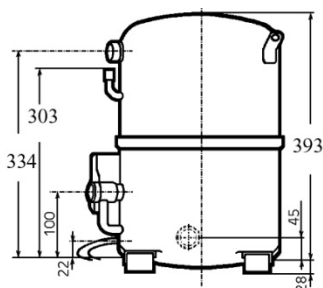

* EN 12900: T° cond. +50°C / T° évap. +5°C / T° gas aspirés. +20°C / Sous refroidissement. 0K

* EN 12900: Cond. T° +50°C / Evap. T° +5°C / Return gas T° +20°C / Subcooling. 0K

Cylindrique / *Displacement* : 145 cm³
Poids net / *Net weight* : 48.1 Kg
Charge en huile / *Oil charge* : 1960 cm³
Type d'huile / *Oil type* : P.O.E /
Détente / *Expansion device* : Capillaire/Détendeur
Capillary/Exp° valve
Refroidissement / *Cooling* : Ventilé / *Forced*

Résistance à 20° C / *Windings resistances at 20° C*
Phases 1,2,3. / *Phase Nr 1,2,3* : 1.63 Ohms

Intensité / *Current*
nom. / *Rated current RLA* : 12.2 / 13.7 A
max. / *Max current* : 20 / 19.5 A
dém. / *Start current LRA* : 83 / 85 A

Ap. Electrique / *Electrical equipment* : TRI

Protecteur / *Overload* : Interne / *Internal*

Pour conduites Ø ext / *For tubing O.D.*

Aspiration <i>Suction</i>	Refolement <i>Discharge</i>	Charge <i>Process</i>
28.6 (1"1/8)	15.9 (5/8")	6.35 (1/4")

Les caractéristiques données dans cette fiche technique peuvent évoluer sans avis préalable, avec les améliorations que "TECUMSEH EUROPE" entend toujours apporter à sa production.
"TECUMSEH EUROPE", in a constant endeavour to improve its products reserves the right to change any information contained in this leaflet without prior warning.



TAG4581T	Tension T : 400V 3~ 50Hz / 440V 3~ 60 Hz	R22	N°237MU-T	Ind a
-----------------	---	------------	------------------	--------------

Les performances sont données dans les **conditions EN 12900** :
 Gaz aspirés : 20°C
 Sous refroidissement : 0°K

The performance data are in **EN 12900 conditions** :
 Return gas : 20°C
 Subcooling : 0°K

50 Hz R22

4 T condensation	5 T évaporation	(°C)	-25	-20	-15	-10	-5	0	5	10	15
30	1 P frigorifique	(W)	5662	7462	9588	12088	15013	18413	22338	26839	31965
	2 P absorbée	(W)	3106	3544	3948	4332	4714	5107	5526	5988	6507
	3 I absorbée	(A)	7.59	8.04	8.48	8.92	9.36	9.8	10.23	10.67	11.11
40	1 P frigorifique	(W)		6287	8231	10501	13145	16216	19763	23836	28486
	2 P absorbée	(W)		3695	4215	4696	5151	5597	6049	6521	7030
	3 I absorbée	(A)		8.14	8.74	9.34	9.94	10.54	11.14	11.73	12.33
50	1 P frigorifique	(W)			6855	8890	11250	13988	17152	20793	24961
	2 P absorbée	(W)			4366	4989	5565	6111	6641	7170	7714
	3 I absorbée	(A)			8.91	9.66	10.42	11.18	11.94	12.69	13.45
60	1 P frigorifique	(W)				7297	9369	11768	14545	17749	21432
	2 P absorbée	(W)				5135	5878	6570	7224	7857	8483
	3 I absorbée	(A)				9.89	10.81	11.72	12.64	13.55	14.47

60 Hz R22

4 T condensation	5 T évaporation	(°C)	-25	-20	-15	-10	-5	0	5	10	15
30	1 P frigorifique	(W)	6410	8557	11094	14078	17569	21625	26304	31665	37765
	2 P absorbée	(W)	3566	4129	4678	5229	5797	6396	7042	7750	8534
	3 I absorbée	(A)	6.39	7.01	7.63	8.25	8.86	9.46	10.06	10.66	11.25
40	1 P frigorifique	(W)		7278	9610	12321	15471	19118	23320	28135	33623
	2 P absorbée	(W)		4310	4966	5609	6255	6917	7611	8353	9156
	3 I absorbée	(A)		7.11	7.91	8.71	9.51	10.29	11.08	11.86	12.63
50	1 P frigorifique	(W)			8070	10511	13322	16563	20290	24563	29440
	2 P absorbée	(W)			5161	5921	6668	7418	8186	8986	9833
	3 I absorbée	(A)			8.07	9.05	10.03	11	11.97	12.94	13.9
60	1 P frigorifique	(W)				8681	11156	13993	17248	20981	25250
	2 P absorbée	(W)				6135	7009	7872	8737	9620	10537
	3 I absorbée	(A)				9.26	10.43	11.59	12.74	13.89	15.03

1 = refrigerating capacity 2 = watt input 3 = current 4 = condensing temperature 5 = evaporating temperature

Nota : Les caractéristiques données dans cette fiche technique peuvent évoluer sans avis préalable, avec les améliorations que "TECUMSEH EUROPE" entend toujours apporter à sa production.

Note : "TECUMSEH EUROPE", in a constant endeavour to improve its products reserves the right to change any information contained in this leaflet without prior warning.



AG Outlines Drawings

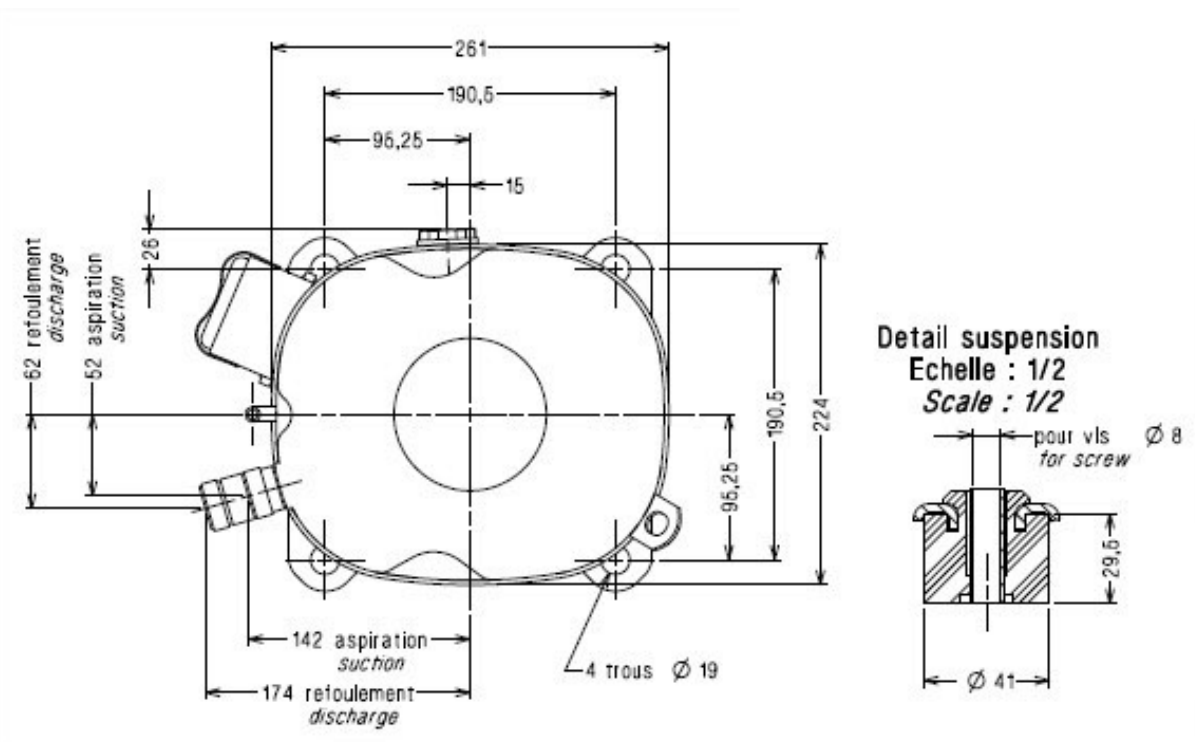
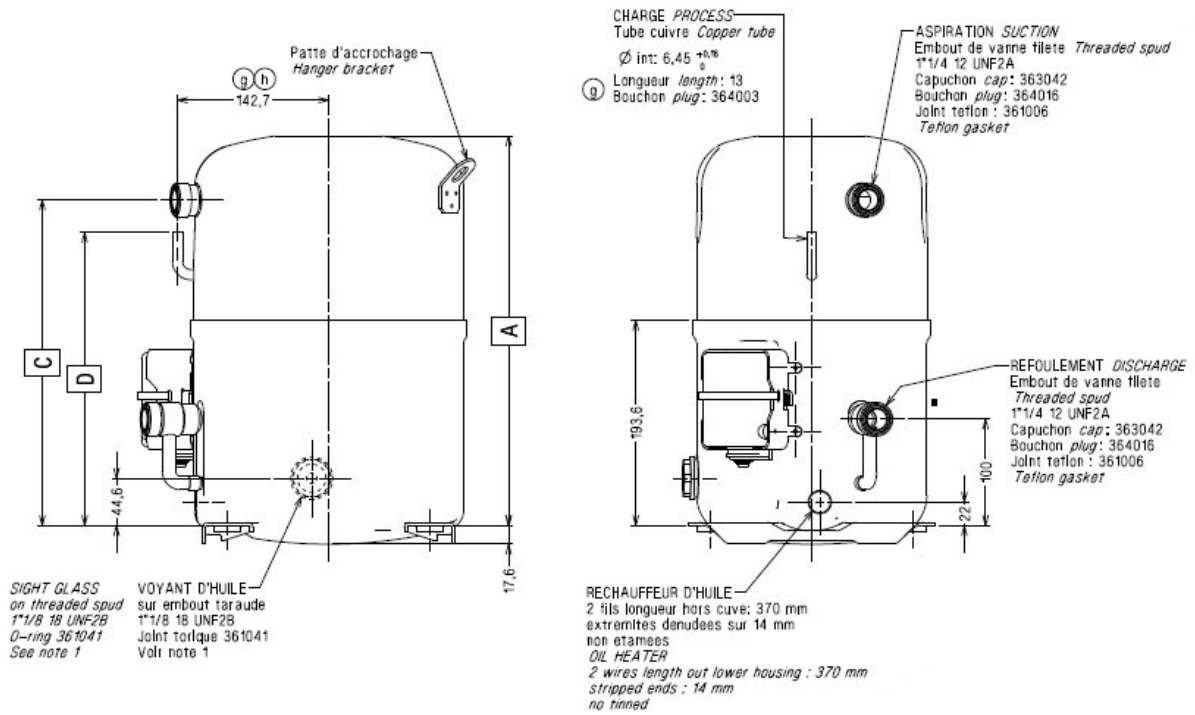

AG Benchmark Positive Refrigeration

Commercial Positive Refrigeration

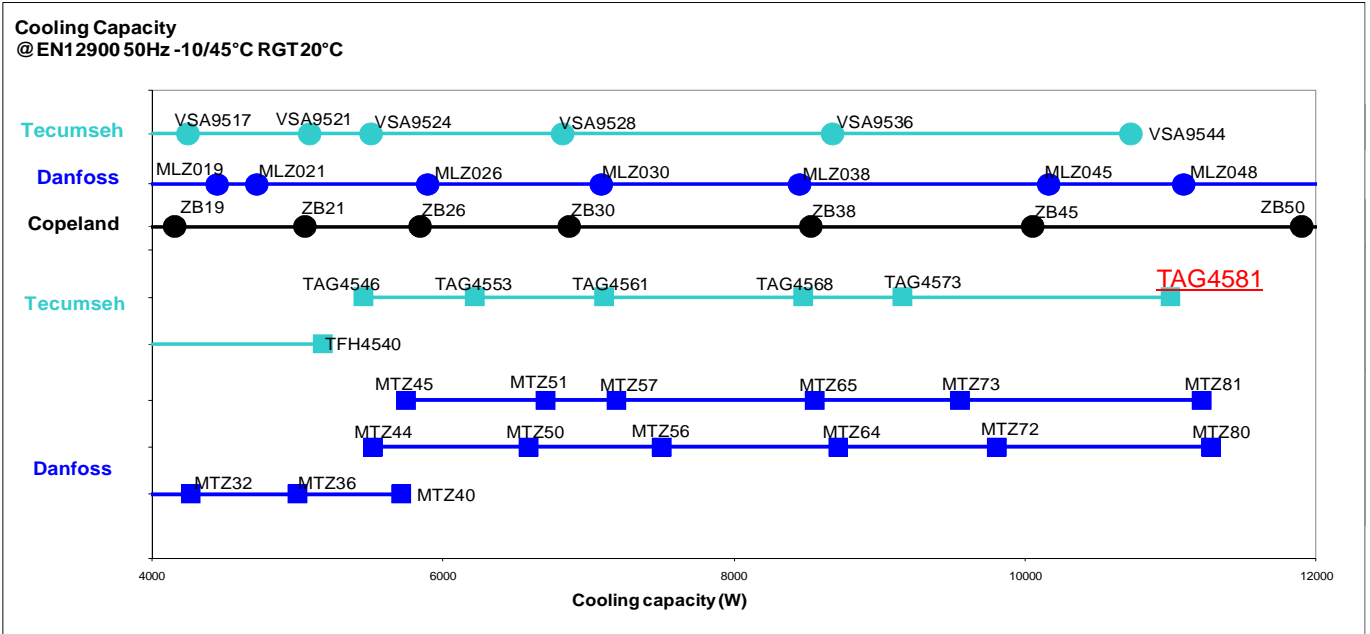

Tecumseh										Danfoss					Copeland								
Technologies	Families	Models	Cooling Capacity	Target cooling capacity	%	COP	Target COP	%	Weight	Technologies	Families	Models	Cooling Capacity	COP	Net weight	Technologies	Families	Models	Cooling Capacity	COP	Net weight		
Scroll	Tecumseh VSA	7	VSA9510Z	2339		1,64			35 kg	Piston	Danfoss MTZ	4	MTZ018-4	2041	1,69	21 kg	Scroll	Copeland ZB	9	ZB15KCE	3320	1,82	26 kg
Scroll	VSA	7	VSA9514Z	3145		1,59			36 kg	Piston	MTZ	4	MTZ022-4	2812	1,9	21 kg	Scroll	ZB	9	ZB19KCE	4160	1,98	28 kg
Scroll	VSA	7	VSA9517Z	4247		2,01			35 kg	Piston	MTZ	4	MTZ028-4	3672	1,88	23 kg	Scroll	ZB	9	ZB21KCE	5050	2,01	29 kg
Scroll	VSA	7	VSA9521Z	5085		2,1			36 kg	Piston	MTZ	4	MTZ032-4	4267	1,98	24 kg	Scroll	ZB	9	ZB26KCE	5840	1,98	28 kg
Scroll	VSA	7	VSA9524Z	5505		2,08			36 kg	Piston	MTZ	4	MTZ036-4	5003	1,94	25 kg	Scroll	ZB	9	ZB30KCE	6870	2,05	36 kg
Scroll	VSA	7	VSA9528Z	6823		2,12			52 kg	Piston	MTZ	4	MTZ040-4	5714	1,94	26 kg	Scroll	ZB	9	ZB38KCE	8530	2,03	38 kg
Scroll	VSA	7	VSA9536Z	8676		2,19			55 kg	Piston	Danfoss MTZ	5	MTZ044-4	5520	1,75	35 kg	Scroll	ZB	9	ZB45KCE	10050	2,09	40 kg
Scroll	VSA	7	VSA9544Z	10728		2,13			59 kg	Piston	MTZ	5	MTZ050-4	6591	1,83	35 kg	Scroll	ZB	9	ZB50KCE	11900	2,08	57 kg
Piston	Tecumseh TFH	1	TFH4522Z	2617		1,69			30 kg	Piston	MTZ	5	MTZ056-4	7501	1,87	37 kg	Scroll	ZB	9	ZB58KCE	13300	2,11	57 kg
Piston	TFH / TFHD	1	TFH4524Z	3048		1,75			30,4 kg	Piston	MTZ	5	MTZ064-4	8713	1,92	37 kg	Scroll	ZB	9	ZB66KCE	15100	2,13	60 kg
Piston	TFH / TFHD	1	TFH4531Z	3968		1,85			31,2 kg	Piston	MTZ	5	MTZ072-4	9807	1,97	40 kg	Scroll	ZB	9	ZB76KCE	17850	2,19	61 kg
Piston	TFH / TFHD	1	TFH4540Z	5173		1,79			33 kg	Piston	MTZ	5	MTZ080-4	11276	1,93	40 kg	Scroll	ZB	9	ZB95KCE	21700	2,07	65 kg
Piston	TFH / TFHD	1	TFHD4548Z	6095		1,75			76,9 kg	Piston	Danfoss MTZ	6	MTZ045-4	5749	2,07	35 kg							
Piston	TFH / TFHD	1	TFHD4580Z	10345		1,79			82 kg	Piston	MTZ	6	MTZ051-4	6703	2,08	35 kg							
Piston	TFH / TFHD	1	TFHD4562Z	7937		1,85			78 kg	Piston	MTZ	6	MTZ057-4	7189	2,05	37 kg							
Piston	Tecumseh TAG	2	TAG4546Z	5457	5800	6,29%	1,85	2,05	10,81%	44 kg	Piston	MTZ	6	MTZ065-4	8552	2,03	37 kg						
Piston	TAG / TAGD	2	TAG4553Z	6220	6500	4,50%	1,85	2,05	10,81%	45,6 kg	Piston	MTZ	6	MTZ073-4	9555	2,04	40 kg						
Piston	TAG / TAGD	2	TAG4561Z	7107	7200	1,31%	1,88	2,05	9,04%	46 kg	Piston	MTZ	6	MTZ081-4	11214	2	40 kg						
Piston	TAG / TAGD	2	TAG4568Z	8477	8600	1,45%	2	2,1	5,00%	47,2 kg	Piston	MTZ	9	MTZ100-4	13156	1,95	60 kg						
Piston	TAG / TAGD	2	TAG4573Z	9156	9500	3,76%	1,94	2,1	8,25%	48 kg	Piston	MTZ	9	MTZ125-4	16831	1,99	64 kg						
Piston	TAG / TAGD	2	AG4580ZOpt	11000	11000		1,94	2,1	0,0825%	48 kg	Piston	MTZ	9	MTZ144-4	19816	2,03	67 kg						
Piston	TAG / TAGD	2	AG4580ZOpt	11000			1,94				Piston	MTZ	9	MTZ160-4	21756	1,96	69 kg						
Piston	TAG / TAGD	2	TAGD4590Z	10915			1,85		104 kg	Scroll	Danfoss MLZ	8	MLZ015T4	3302	1,89	31 kg							
Piston	TAG / TAGD	2	TAGD4610Z	12440			1,85		109 kg	Scroll	MLZ	8	MLZ019T4	4451	2,06	31 kg							
Piston	TAG / TAGD	2	TAGD4612Z	14214			1,88		111 kg	Scroll	MLZ	8	MLZ021T4	4721	2,08	31 kg							
Piston	TAG / TAGD	2	TAGD4614Z	16954			2		113 kg	Scroll	MLZ	8	MLZ026T4	5896	2,09	31 kg							
Piston	TAG / TAGD	2	TAGD4615Z	18312			1,94		113 kg	Scroll	MLZ	8	MLZ030T4	7088	2,12	38 kg							
										Scroll	MLZ	8	MLZ038T4	8452	2,13	38 kg							
										Scroll	MLZ	8	MLZ045T4	10161	2,11	38 kg							
										Scroll	MLZ	8	MLZ048T4	11091	2,14	38 kg							
										Scroll	MLZ	8	MLZ058T4	12841	2,07	44 kg							
										Scroll	MLZ	8	MLZ066T4	15187	2,19	46 kg							
										Scroll	MLZ	8	MLZ076T4	17317	2,18	46 kg							

TAG4581Z allows to compete with the MTZ8081 of Danfoss.

AG Benchmark

TAG4581Z / MTZ081

Sound Power Level Comparison: Danfoss / Maneurop

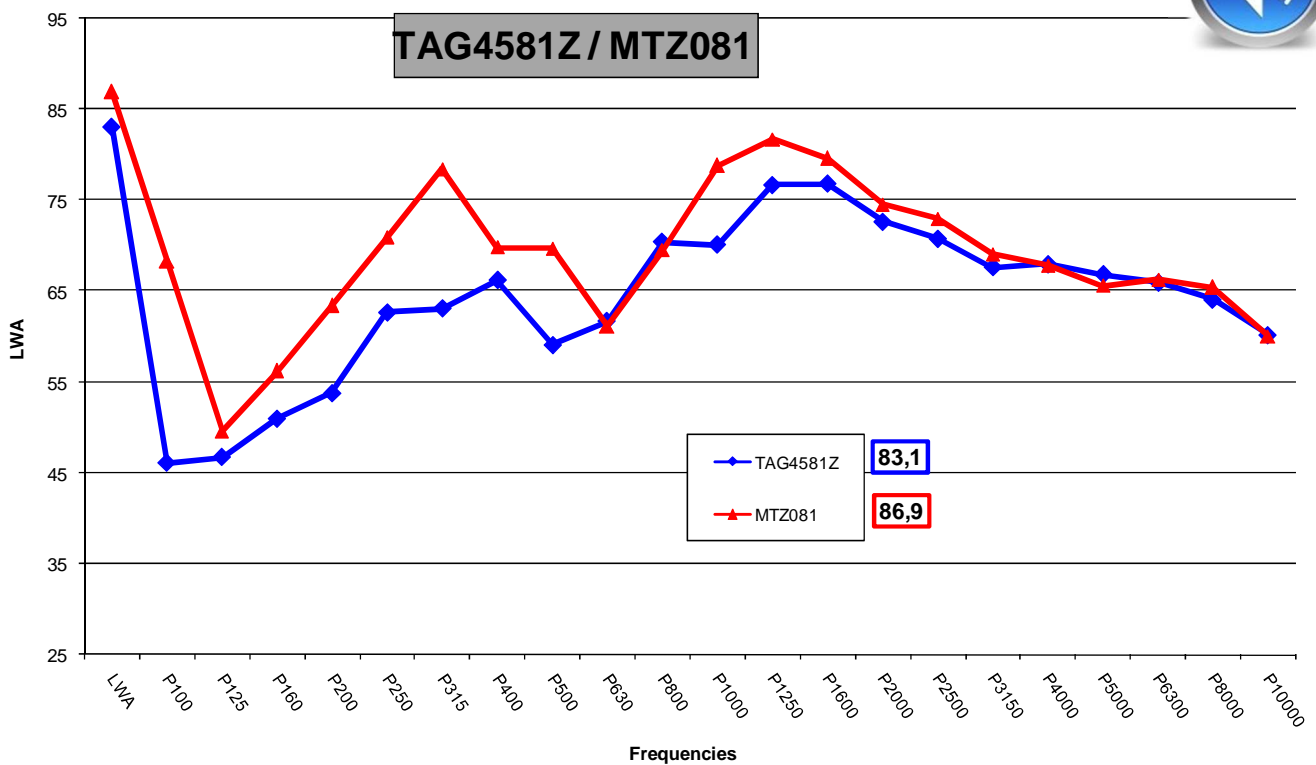

→ TAG 4581Z better acoustic level (-3 dBA) than the MTZ081

AG Benchmark TAG4581Z / MTZ081

Cooling Capacity Comparison

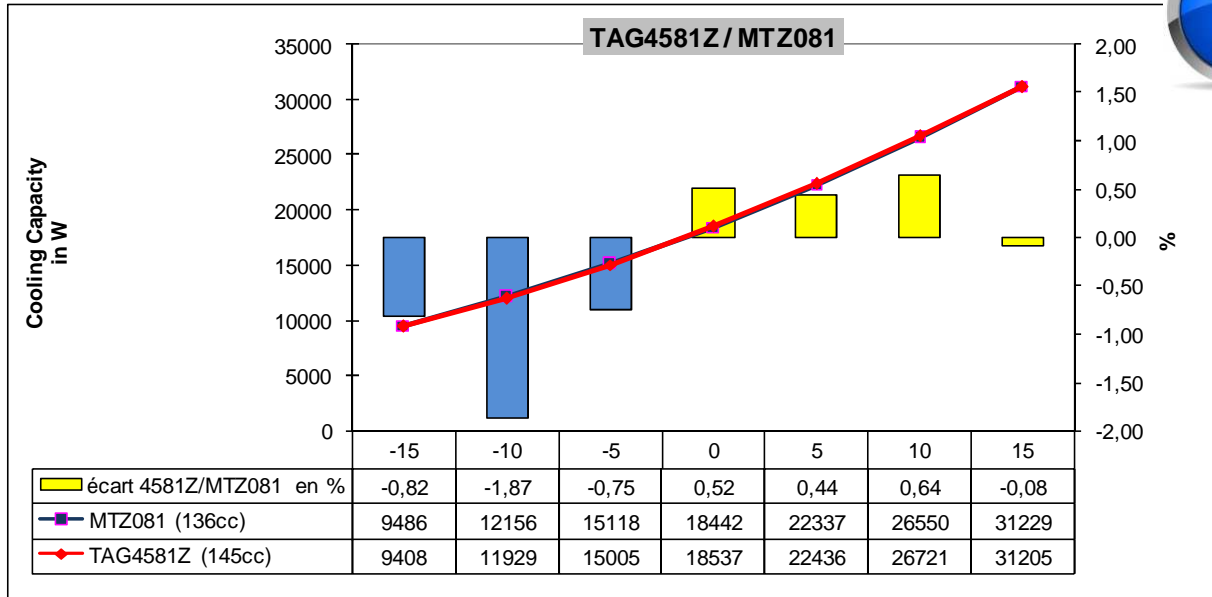

→ TAG 4581Z have the same cooling capacity than MTZ081

Energy Efficiency Comparison

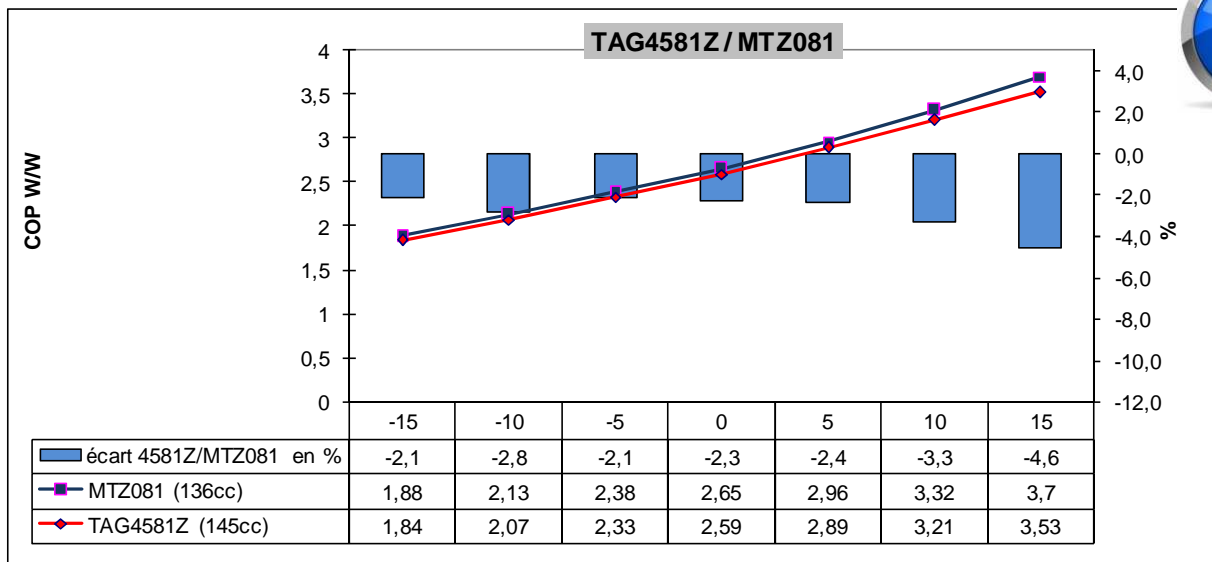

→ TAG 4581Z have similar efficiency of MTZ081

AG Benchmark Negative Refrigeration

Commercial Negative Refrigeration

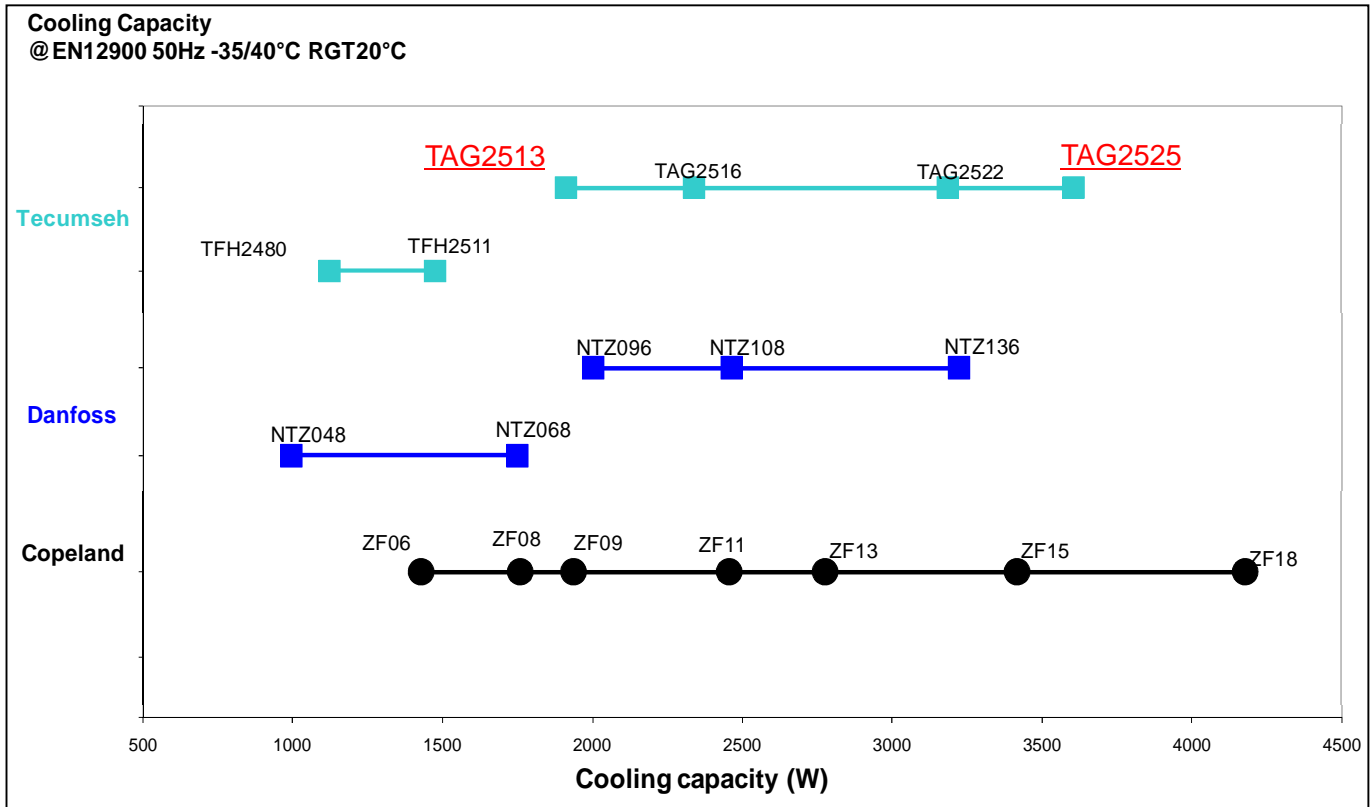

Negative refrigeration - R404A - EN 12900, evaporating T° -35°C / condensing T° 40°C / RGT 40°C

Tecumseh									Danfoss					Copeland							
Technologies	Families	Models	Cooling Capacity	Target cooling capacity	COP	Target COP	Weight	Technologies	Families	Models	Cooling Capacity	COP	Net weight	Technologies	Families	Models	Cooling Capacity	COP	Net weight		
Piston	tecumseh TFH	1	TFH2480Z	1125		1,02	33 kg	Piston	infoss NT	3	NTZ048-4	995	1,15	21 kg							
Piston	TFH / TFHD	1	TFH2511Z	1477		1,09	33 kg	Piston	NTZ	3	NTZ068-4	1750	1,15	23 kg	Scroll	opeland Z	6	ZF06K4E	1430	1,03	26 kg
Piston	TFH / TFHD	1	TFHD2522Z	2953		1,09	79 kg	Piston	infoss NT	4	NTZ096-4	2002	1,15	35 kg	Scroll	ZF	6	ZF08K4E	1760	1,08	27 kg
Piston	TFH / TFHD	1	TFHD2516Z	2250		1,02	79 kg	Piston	NTZ	4	NTZ108-4	2465	1,19	35 kg	Scroll	ZF	6	ZF09K4E	1940	1,09	27 kg
Piston	tecumseh TA	2	TAG2513Z	1913		1,12		Piston	NTZ	4	NTZ136-4	3225	1,11	35 kg	Scroll	ZF	6	ZF11K4E	2460	1,14	28 kg
Piston	TAG/TAGD	2	TAG2516Z	2341	2450	1,11	45 kg							Scroll	ZF	6	ZF13K4E	2780	1,19	38 kg	
Piston	TAG/TAGD	2	TAG2522Z	3187	3300	1,17	47 kg	Piston	NTZ	5	NTZ215-4	4948	1,19	62 kg	Scroll	ZF	6	ZF15K4E	3420	1,21	39 kg
Piston		2	TAG25???Z	3607	4200	1,14	1,2	Piston	NTZ	5	NTZ271-4	6955	1,24	64 kg	Scroll	ZF	6	ZF18K4E	4180	1,22	41 kg
Piston	TAG/TAGD	2	TAGD2532Z	4702		1,12	104 kg														
Piston	TAG/TAGD	2	TAGD2544Z	6377		1,17	111 kg														

Scroll	ZF	7	ZF33K4E	7090	1,22	93 kg
Scroll	ZF	7	ZF40K4E	8780	1,18	103 kg
Scroll	ZF	7	ZF48K4E	10600	1,09	112 kg

AG Benchmark

TAG2525Z / NTZ136

Sound Power Level Comparison: Danfoss / Maneurop

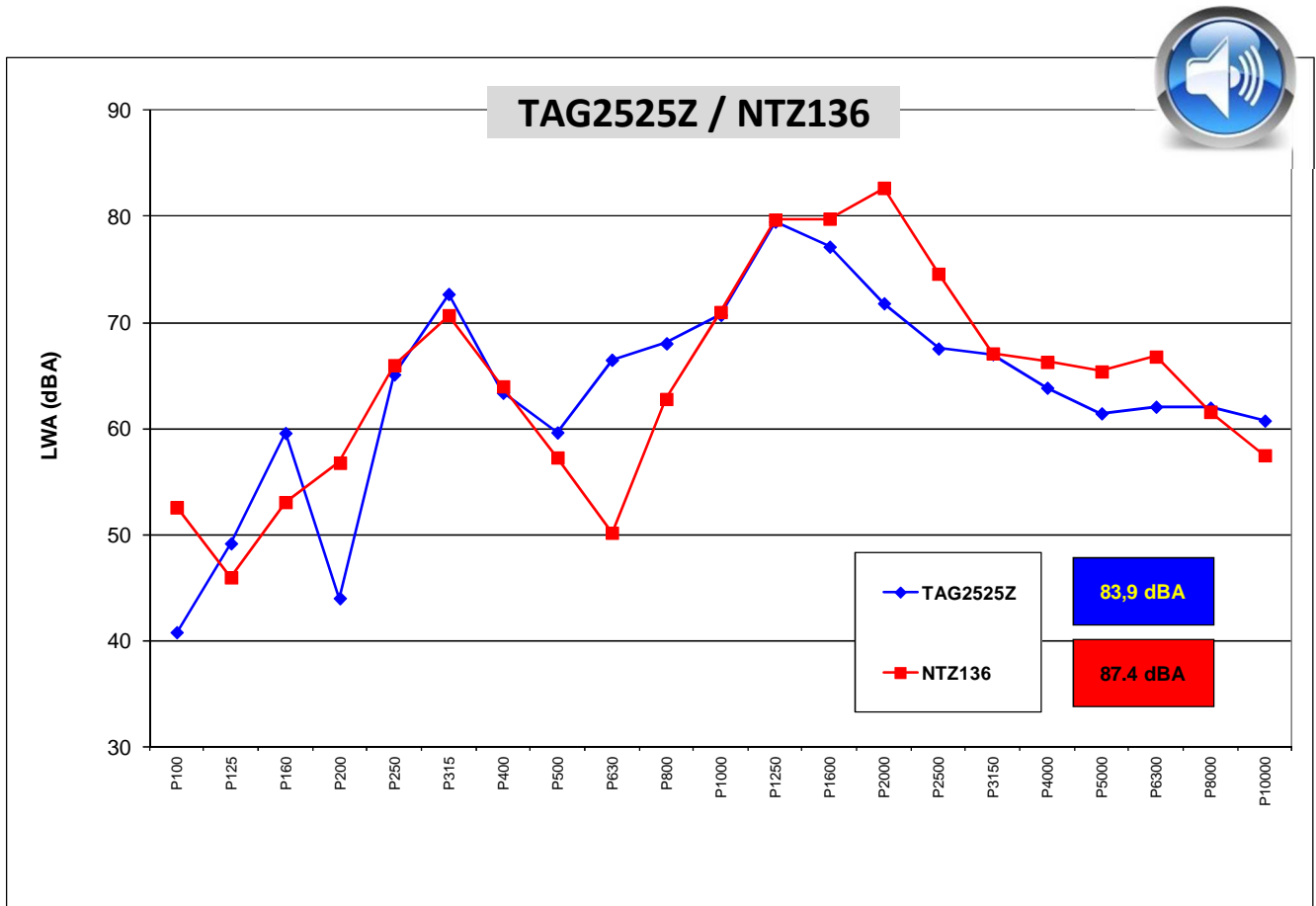

AG Benchmark

TAG2525Z / NTZ136

Cooling capacity comparison : TAG and NTZ have similar capacity

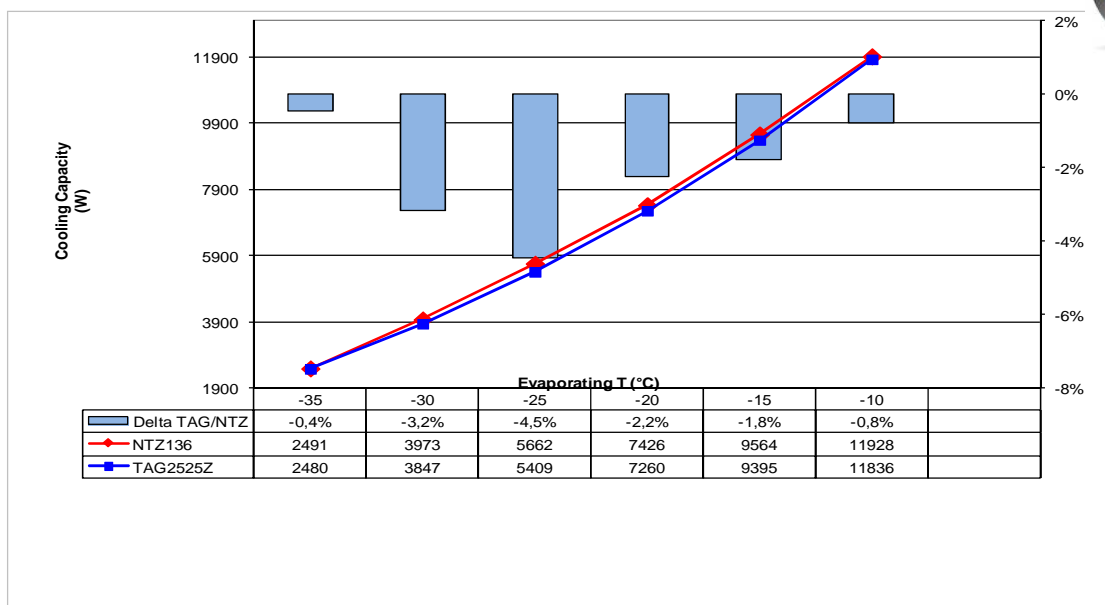

Efficiency comparison : TAG compresseur is better than NTZ of 3 to 7%

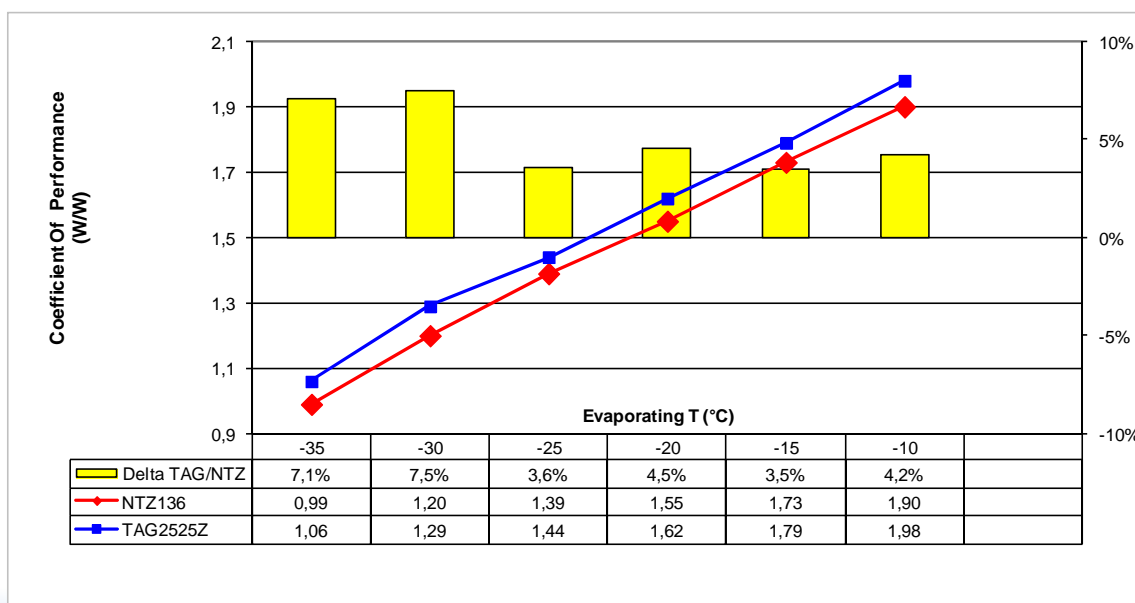

AG Multiple and Unitary Packaging

Number of layer per Pallet	Total Quantity per Pallet	Pallet Dimensions	Volume m ³
2	18	1125 x 800 x 1005	0.905

→ Multiple and unitary have the same pallet quantity.

Multiple Packaging

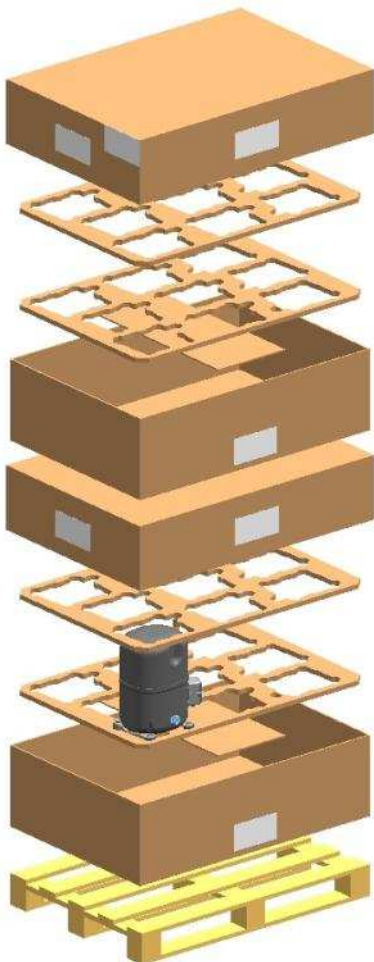

Unitary Packaging

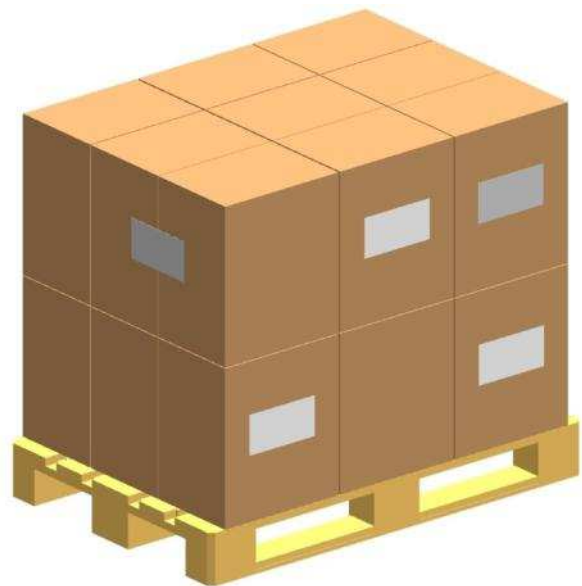

Marketing Tools

AG Hermetic Compressors Flyer

COMMERCIAL REFRIGERATION

AG HERMETIC COMPRESSORS

The AG range is expanding with 3 new models:

FA23515T	Positive refrigeration
FA23515Z	No positive refrigeration

They are designed and assembled based on the values that hold the reputation of the AG range. This family is well-known on the market for its reliability and durability.

Reliability for demanding applications
These compressors are widely renowned for their reliability and ability to operate in demanding or difficult applications (for gas defrosting on ice-making machines, or pull-down with start-up outside the vaporating range on milk tanks). AG compressors are a benchmark on the market for its reliability and durability.

Acoustics for greater comfort
Improving the compressor noise level is a priority for Tecumseh. The modifications made to the mechanics and quality of lubrication have reduced the noise level of AG compressors up to 5 dB(A). These improvements make AG compressors among the quietest on the market.

Modularity for greater competitiveness
All compressors are suited to refrigerating systems with large power variations, which can operate with a central plant. AGP compressors are equipped as standard with an oil sight glass indicator and an oil-equalization connector-equalizer coating so that they can be installed quickly and easily on the central plant, to boost and modulate the power.

Guaranteed Performance
As an active member of Aucorinc, Tecumseh guarantees the refrigeration performance level and energy efficiency level of its AG compressors. To this end, Tecumseh offers reliable and transparent information to customers and users, to reinforce trust in the solutions it provides. For its customers, this is also a competitive advantage in winning the trust of their own customers.

Powerful, Innovative, High-Performance
A technology you can count on

Hermetic Compressors Brochure

COMMERCIAL REFRIGERATION

HERMETIC COMPRESSORS

Powerful, Innovative, High-Performance
Technologies you can count on

Condensing Units Brochure

COMMERCIAL REFRIGERATION

CONDENSING UNITS

Standard, Customisable, Ready to Install
A tailor-made offer

Cross Reference [here](#)

CROSS REF

Find out the **Cross Reference**

Tool ergonomically and functionally helps you determine which Tecumseh compressor is equivalent to a competitive model.

Click on the link to the right for download.

- » OUTIL D'EQUIVALENCE COMPRESSEURS
- » EQUIVALENTS PROGRAM COMPRESSORS
- » VERGLEICHSLISTE VERDICHTER
- » LISTA DE EQUIVALENCIAS COMPRESORES
- » STRUMENTO DE EQUIVALENZA COMPRESSORI

Selection Software [here](#)

Logiciel de sélection - Compresseurs hermétiques et groupes de condensation.
Selection program - Hermetic compressors and condensing units.
Auswahlprogramm - Vollhermetische Verdichter und Verflüssigungssätze.
Programa de selección - Compresores herméticos y grupos de condensación.
Programma di selezione - Compressori ermetici e unità condensatrici.
Программа выбора - Герметичные компрессоры и агрегаты.
Program doboru - hermetyczne sprężarki i agregaty skraplające

Tecumseh

Selection software allows you to choose your product depending on its power and your application.

Now available in seven languages.

Click on the language-specific link to the right for download.

Available in English, French, German, Spanish, Italian, Russian and Polish

Tecumseh Europe - Headquarter
2 av. Blaise Pascal • Bat. B
38090 VAULX MILIEU • France
Tel: +33 (0) 4 74 82 24 00

For more information on products
by Tecumseh, please visit our
website www.tecumseh.com

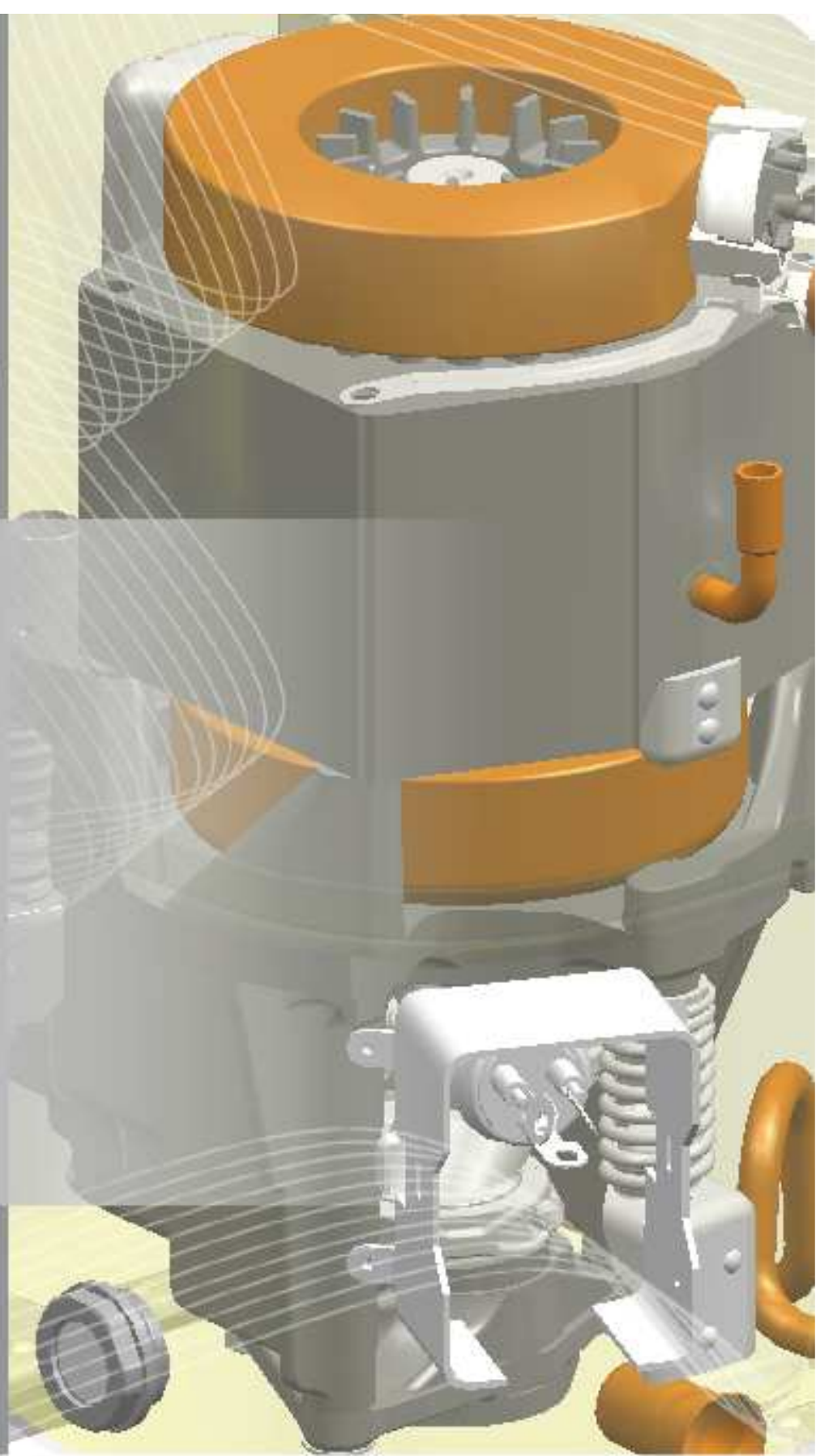

Tecumseh