

220-240V 1~

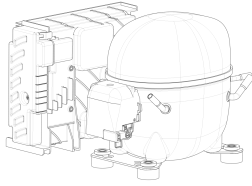

**GENERAL DATA**

**Application:** HBP  
**Refrigerant:** R134a  
**Evaporating Temperature Range:** -15°C to 10°C  
**Compressor Cooling:** Fan  
**Fan air flow:** 520 m<sup>3</sup>/h  
**Type:** Hermetic reciprocating  
**Technology Type:** VCC  
**Expansion Device:** Capillary Tube or Expansion Valve  
**Packing Quantity:** Multi - 40 pcs  
**Displacement:** 9.99 cm<sup>3</sup>

Approvals:   

**MECHANICAL DATA**

**Bore:** 26.5 mm  
**Stroke:** 18.12 mm  
**Oil Charge:** 500ml +/-15ml  
**Free Internal Volume:** 2.1 cm<sup>3</sup>  
**Maximum Recommended Refrigerant Charge:** 350 g  
**Oil Type Configuration:** Polyolester  
**Oil Type Viscosity:** ISO22  
**Compressor pressurization:** Dry air charge  
**Weight:** 13.8 kg

**ELECTRICAL DATA**

**Motor Type:** BPM  
**Starting Torque:** HST  
**Voltage working range at 50 Hz:** 150 (160)-240 V  
**Voltage working range at 60 Hz:** 150 (160) V  
**Maximum Motor Temperature:** 130 °C  
**Start Winding Resistance:** 3.82 Ω (± 10%) at 25°C  
**Run Winding Resistance:** 2.53 Ω (± 10%) at 25°C  
**Locked Rotor Amperage (LRA):** 6 A

**MOUNTING ACCESSORIES**

	Description	Code
<b>Terminal Board:</b>	no	-
<b>Capacitor Bracket:</b>	no	-
<b>Grommets:</b>	yes	2221004
<b>Sleeves:</b>	yes	2222016
<b>Washer:</b>	no	-
<b>Pin:</b>	no	-
<b>Clip:</b>	no	-
<b>Rotolock valve:</b>	no	-
<b>Cover:</b>	yes	2075282
<b>Anchorage:</b>	yes	1027058
<b>Overload Protector Bracket:</b>	yes	2075299

**ELECTRICAL COMPONENTS**

	Component type	Description	Code
<b>Inverter:</b>	HP DROP IN	800W 220V	519302007
<b>Motor Protection:</b>	External 3/4"	MST22AMK-3166	2288315

**EXTERNAL CHARACTERISTICS**

**Base Plate:** Universal  
**Tray Holder:** No  
**Height:** 206 mm

	Internal Diameter (mm)	Material	Shape
<b>Suction Connector</b>	8.1	Copper	Slanted 42°
<b>Discharge Connector</b>	6.45	Copper	Straight
<b>Process Connector</b>	6.45	Copper	Slanted 42°

**RATED POINT DATA**

Cooling Capacity (W)	Power Consumption (W)	Current Consumption (A)	Gas Flow Rate (kg/h)	Efficiency (W/W)
±5%	±5%	±5%	±5%	±7%
641	247	1.03	14.95	2.60

Test condition: EN 12900, Fan, Return Gas 20°C, Subcooling 0K, Evaporating: 5°C, Condensing: 50°C, Ambient: 35°C

**PERFORMANCE CURVE DATA**

**2000 RPM**

Condensing Temperature (°C)	Evaporating Temperature (°C)	Cooling Capacity (W)	Power Consumption (W)	Current Consumption (A)	Gas Flow Rate (kg/h)	Efficiency (W/W)
		±5%	±5%	±5%	±5%	±7%
<b>35°C</b>	10	953	217	0.90	19.52	4.39
	5	782	205	0.84	15.91	3.81
	0	632	192	0.79	12.77	3.29
	-5	502	178	0.73	10.10	2.82
	-10	393	163	0.67	7.87	2.41
	-15	304	147	0.60	6.06	2.07

Condensing Temperature (°C)	Evaporating Temperature (°C)	Cooling Capacity (W)	Power Consumption (W)	Current Consumption (A)	Gas Flow Rate (kg/h)	Efficiency (W/W)
		±5%	±5%	±5%	±5%	±7%
<b>45°C</b>	10	841	247	1.03	18.81	3.40
	5	691	233	0.97	15.34	2.96
	0	559	217	0.90	12.33	2.57
	-5	445	200	0.82	9.77	2.22
	-10	350	182	0.74	7.64	1.93
	-15	273	161	0.66	5.93	1.69

Condensing Temperature (°C)	Evaporating Temperature (°C)	Cooling Capacity (W)	Power Consumption (W)	Current Consumption (A)	Gas Flow Rate (kg/h)	Efficiency (W/W)
		±5%	±5%	±5%	±5%	±7%
<b>55°C</b>	10	720	279	1.20	17.83	2.58
	5	590	261	1.10	14.49	2.26
	0	476	240	1.01	11.60	1.98
	-5	378	218	0.91	9.15	1.73
	-10	296	194	0.80	7.13	1.52

Test condition: EN 12900, Fan, Return Gas 20°C, Subcooling 0K, Ambient: 35°C

**ASSEMBLY INSTRUCTION**

**WIRING DIAGRAM**

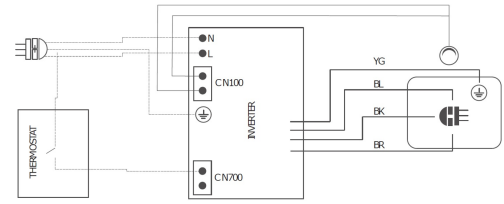
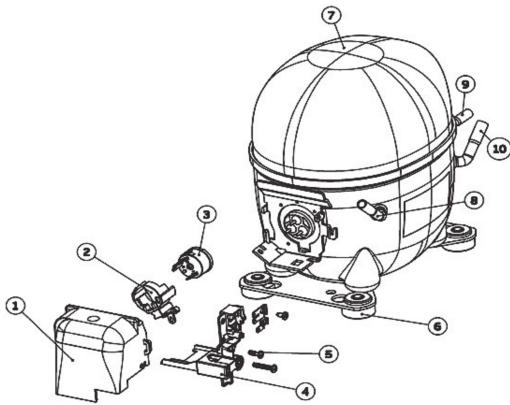

**OPERATING ENVELOPE**

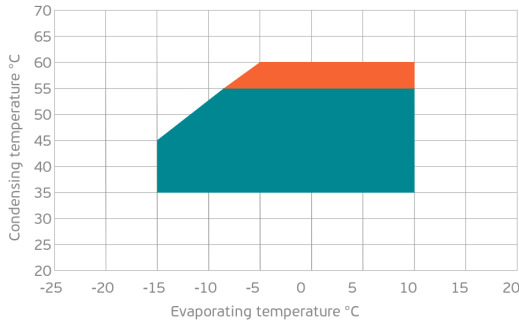

- Operating Condition
- Transient Condition
- Superheating

**NOTE:** usage of compressors outside of intended working range cannot make use of the warranty, or should be consulted with Technical support.

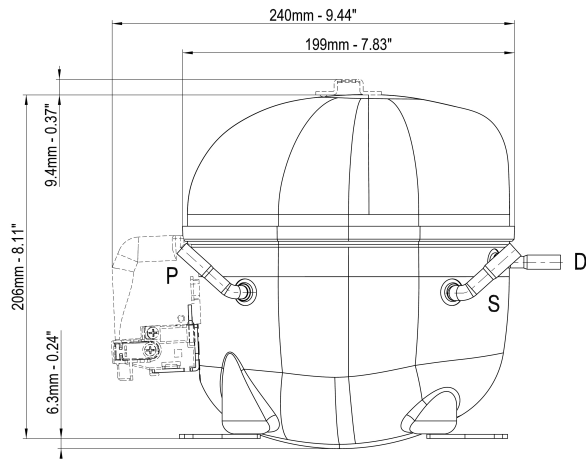

	∅ mm	∅ in	Material
<b>S - Suction</b>	8.10 - 8.20	0.32	Cu
<b>P - Process</b>	6.45 - 6.55	0.25	Cu
<b>D - Discharge</b>	6.45 - 6.55	0.25	Cu

