

Series W43 Room Humidistats

Introduction

These room humidistats are designed to control humidification or dehumidification equipment. It provides SPDT control.

Description

The sensing element consists of carefully selected and processed human hair, proven to be the most sensitive and stable material known for this application. Under normal conditions these controls retain their sensitivity and accuracy for many years.

Note

These controls are designed for use only as operating controls. Where an operating control failure would result in personal injury or loss of property it is the responsibility of the installer to add devices or systems that protect against, or warn of, control failure.



**W43C
Room Humidistat**

Feature and Benefits

<input type="checkbox"/> Wide range 0 to 90% R.H.	Can be used for most of the applications.
<input type="checkbox"/> Dust tight Penn switch.	Prevents pollution of the contacts by electrostatic influences.
<input type="checkbox"/> SPDT Contacts.	Control can be used for either humidification or dehumidification.
<input type="checkbox"/> Use of human hair.	Proven to be the most sensitive and stable material.
<input type="checkbox"/> Field adjustable high and low limit stops.	Can be set within small ranges. Can be used as dial lock.
<input type="checkbox"/> Separate mounting plate.	Makes mounting very easy.

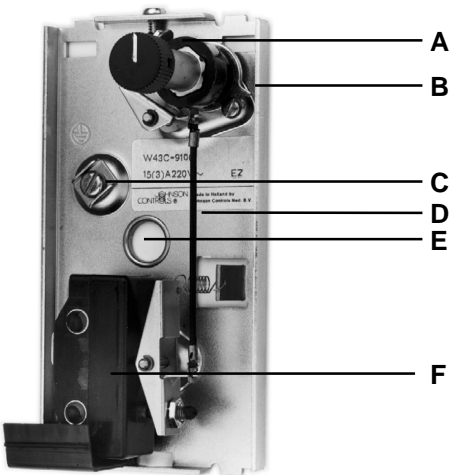

Fig. 1
W43C Room Humidistat, cover removed

- A. High limit stop
- B. Low limit stop
- C. Earthing screw
- D. Hair element
- E. Cable inlet
- F. Contact block

Contact functions

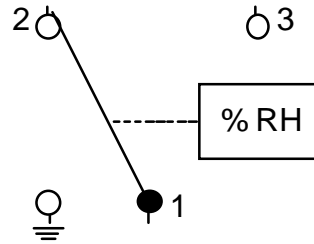

Fig. 2
Contacts 1-3
close on increase in relative humidity .

Contacts 1-2
close on decrease in relative humidity.

Repair and Replacement

Repair is not possible. In case of an improperly functioning control, please check with your nearest supplier. When contacting the supplier for a replacement you should state the type/model number of the control. This number can be found on the data plate or cover label.

Type number selection table

Description	Type number
External knob adjustment	W43C-9100

Dimensions (mm)

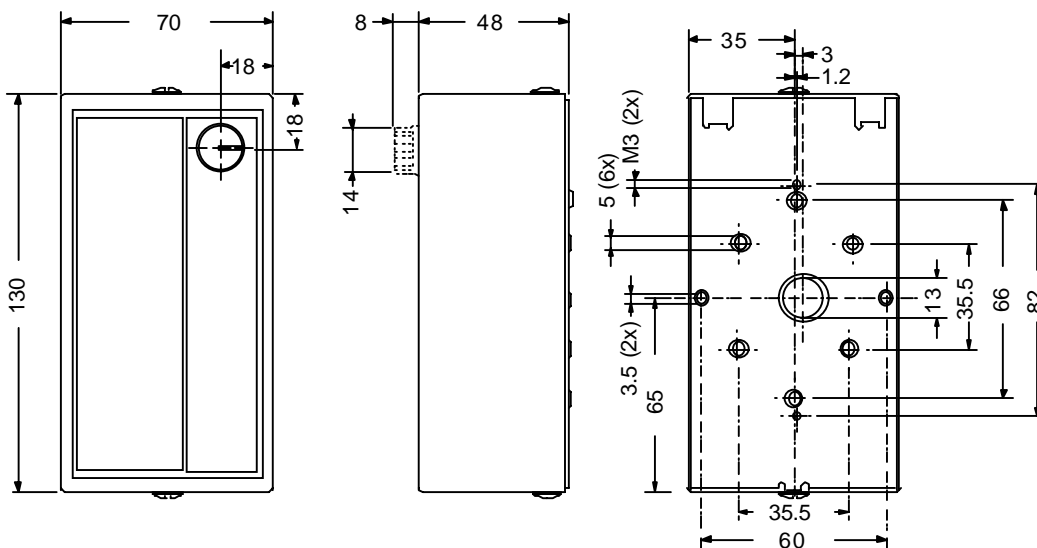

Fig. 3

Note

Specifications

Product type	W43C	
Operating range	0 to 90% R.H.	
Differential	≈ 4% R.H. (fixed)	
Adjustment	External (knob)	
Off Positions	'Deh off'	For dehumidification off turn dial knob to full counter-clockwise position
	'Hum off'	For humidification off turn dial knob to full clockwise position
Limit stops	Field adjustable, high and low limit stops	
Dial Lock	High and low limit stops can be set to prevent dial from being rotated	
Mounting	Flush mounting (separable mounting plate)	
Contact function	SPDT contacts in dust-tight enclosure	
Material	Cover	Sheet metal, tawny silver finish, face plate in two shades of brown
	Sensing element	Specially treated human hair (210 strands)
Enclosure	IP20	
Ambient temperature limits	0 to +40°C	
Electrical ratings	~15(3)A 230V	
Shipping weights	Ind. pack	0.46 kg
	Overpack	11.5 kg (24 pcs.)

The performance specifications are nominal and conform to acceptable industry standards. For applications at conditions beyond these specifications, consult the local Johnson Controls office or representative. Johnson Controls shall not be liable for damages resulting from misapplication or misuse of its products.



Johnson Controls International, Inc.

Headquarters: Milwaukee, WI, USA
 European Headquarters: Westendhof 8, 45143 Essen, Germany
 European Factories: Lomagna (Italy), Leeuwarden (The Netherlands) and Essen (Germany)
 Branch Offices: Principal European Cities.

This document is subject to change

Printed in Europe